



Urinal Flushing Systems

A range of flushing products for urinals offering economical, reliable and hygienic cleaning.

-
- Delabie Electronic and Manual Flushing
 - Water Guard Urinal Flushing Systems
 - Zurn Electronic Flushing Systems
 - Connecting Tubes to Urinals



**MACDONALD
INDUSTRIES LIMITED**



MacDonald Urinal Flushing Systems

MacDonald Industries offer a wide range of products for urinal flushing, from basic push button timed flow controls, suitable for individual bowl urinals, through to electronic sensor activated flushing valves designed to control flushing according to occupancy.

Whilst controlling water wastage is important, hygiene and low maintenance of urinals should be regarded as a priority. There is nothing worse than smelly bathrooms – an

unnecessary distraction for staff, and a real turn off for customers.

Choosing the correct flushing device for the urinal is the first step. The following chart will assist you in making that decision.

All MacDonald Industries urinal flush controls are WELS tested and rated as per star rating on the list below.

URINAL FLUSHING OPTIONS

	WELS RATING	SUIT 1 URINAL	SUIT 2 URINALS	SUIT 3 OR MORE URINALS
TOP INLET URINALS				
DE777800	3	✓		
DE778800	3	✓		
REAR INLET URINALS				
DE430016 / DE430006	5	✓		
DE43006 / DE43000	5	✓		
DE778700	3	✓		
DE777200	3	✓		
DE777130	3	✓		
DE779427	3	✓		
Z-6190WG	0			✓
WG1	0	✓	✓	✓



DELABIE ELECTRONIC URINAL VALVES 4



DELABIE TIME FLOW URINAL FLUSHING SOLUTIONS 6



WATER GUARD URINAL FLUSHING SYSTEMS 8

DELABIE NECK TUBES FOR URINAL VALVES 10

Delabie Sensor Activated Urinal Valves

Delabie has developed an intelligent urinal valve that is able to detect high-frequency periods and to adapt its rinse accordingly. Winner of German Design Award 2018, Tempomatic 4 sets a new standard in urinal flush control.

- 2 stage installation that ensures perfect hydraulic connection. Includes 1st fix connection housing that eliminates the risk of in-wall leaks
- Optional battery or mains powered
- Water connections are made outside the recessing box for ease of installation
- Maintenance is done inside the recessing box
- Waterproof recessing housing:
 - Collar with waterproof seal
 - Hydraulic connection on the outside and maintenance from the front
 - Compatible with wall finishes 10 - 120mm (while maintaining minimum recessing depth of 83mm)
 - Stopcock and flow rate adjustment, filter and solenoid valve are all integrated and accessible from the front
 - Compatible with sea water and grey water
- Shock-resistant infrared presence detection sensor
 - Detection delay is 10 seconds
 - 3 programmes (rinsing volume can be set according to urinal type)
 - High-frequency mode (exclusive to DELABIE):
 - Short rinse after each user
 - Additional rinse at the end of the busy period
- Hygienic after hours flush every 24 hours (can be adjusted to 12 hours or OFF) after the last use: prevents trap dry out
- Flow rate pre-set at 0.15 L/sec. at 3 bar, can be adjusted.

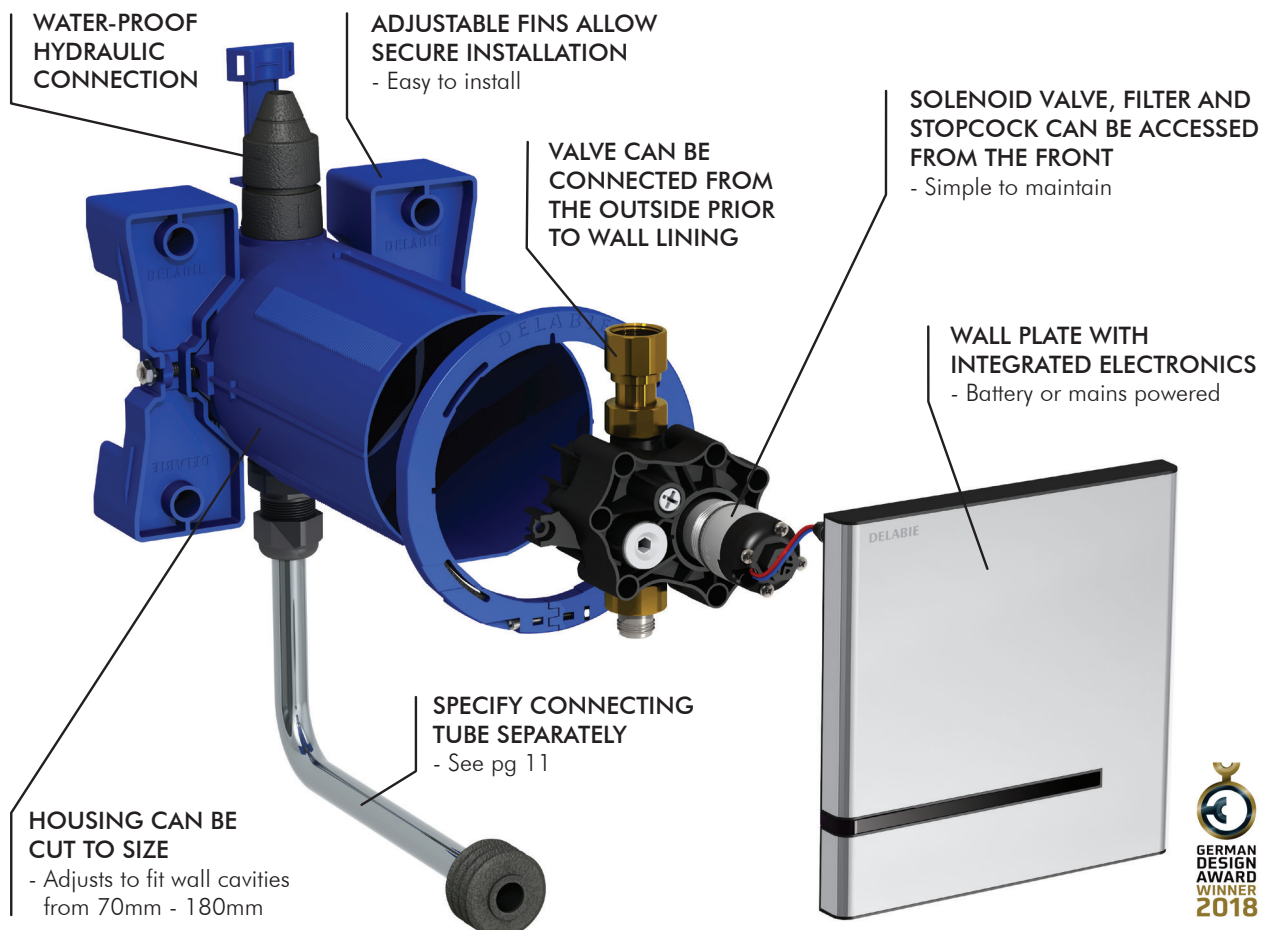

Delabie Tempomatic 4 Urinal Valve - Bright Polished Stainless Steel Finish

DE430016 - Electronic with integrated 6V battery, complete with DE430PBOX

DE430010 - Electronic, mains powered, complete with DE430SBOX

- Specify neck tube separately (pg11)

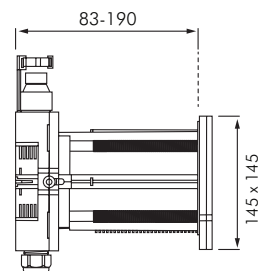
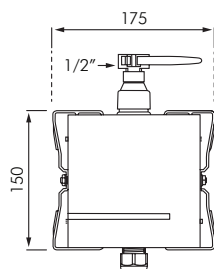

DE430016 shown



Delabie Tempomatic 4 Urinal Valve - Satin Stainless Steel Finish

DE430006 - Electronic with integrated 6V battery, complete with DE430PBOX

DE430000 - Electronic, mains powered, complete with DE430SBOX

- Specify neck tube separately (pg11)

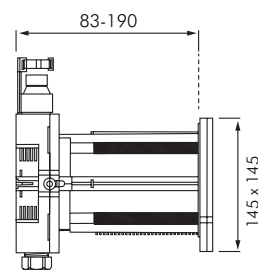
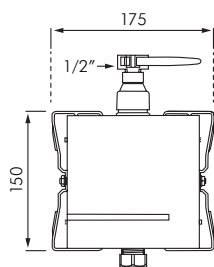

DE430006 shown



Delabie Tempomatic 4 Urinal Valve - Black Ceramic Glass

DE430036 - Electronic with integrated 6V battery, complete with DE430PBOX

DE430030 - Electronic, mains powered, complete with DE430SBOX

- Specify neck tube separately (pg11)

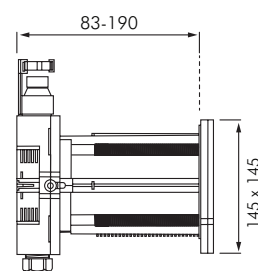
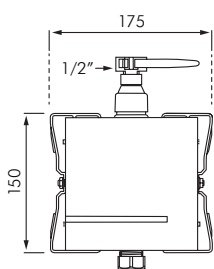

DE430036 shown





Delabie Time Flow Urinal Flushing Solutions

Delabie Urinal Valves are known for their endurance and resistance to vandalism and offer a diverse range of products to fit in perfectly with any commercial installation. Features include short rinsing, optimised time flow, water efficiency, energy saving, and hygiene.

Delabie Tempoflux Valve - Satin Stainless Steel Finish

DE778700 - Complete with DE778BOX

- Soft touch operation
- Stop-cock and flow rate adjustable
- Time flow preset at 3 seconds, can be adjusted from 3-7 seconds
- Compatible with sea water and grey water
- Flow rate pre-set at 0.15L/sec at 300kPa

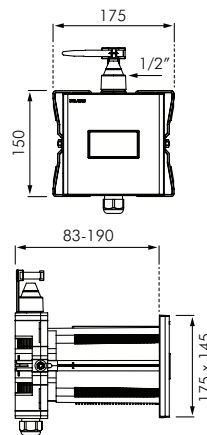

Delabie Tempostop Urinal Valve - Chrome Plated Finish

DE777200 - For cross wall installation >200mm

- Time flow preset at 7 seconds
- M1/2" inline water connections
- Flow rate pre-set at 0.15L/min 300kPa, can be adjusted
- Maintenance through service ducts

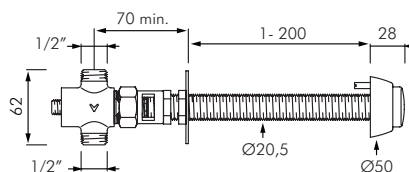

Delabie Temposoft 2 Urinal Valve - Chrome Plated Finish

DE777800 - Time flow 3 seconds

- Straight inline M1/2" water connection
- For wall mounted exposed installation
- Soft-touch operation
- Time flow preset at 3 seconds, can be adjusted from 3-7 seconds
- Flow rate pre-set at 0.15L/sec at 300kPa, can be adjusted

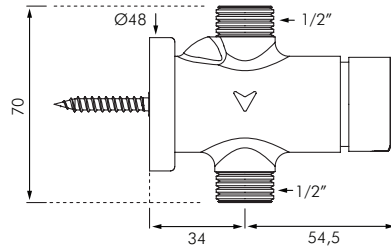

Delabie Temposoft 2 Urinal Valve - Chrome Plated Finish

DE778800 - Time flow 3 seconds

- Angled for recessed inlet
- For wall mounted exposed installation
- Soft touch operation
- Time flow preset at 3 seconds, can be adjusted from 3-7 seconds
- Flow rate pre-set at 0.15L/sec at 300kPa, can be adjusted

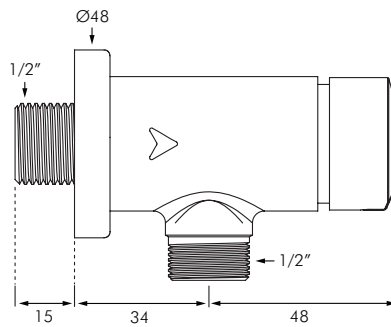

Delabie Temposoft 2 Time Flow Urinal Valve

DE777130 - Time flow 3 seconds

- For recessed installation
- Bright Ø130mm stainless steel face plate
- Soft touch operation
- Time flow preset at 3 seconds, can be adjusted from 3-7 seconds
- Flow rate pre-set at 0.15L/sec at 300kPa, can be adjusted
- Face plate held in place by shroud

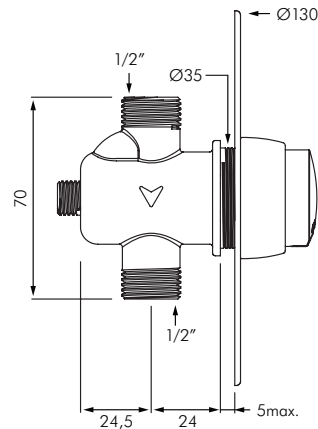

Delabie Tempostop Urinal Valve - Chrome Plated Finish

DE779427 - Time flow 7 seconds

- For recessed installation
- 160 x 160 stainless steel face plate
- Time flow preset at 7 seconds
- Flow rate pre-set at 0.25L/sec at 300kPa, can be adjusted
- Face plate secured in place by 4 x screws

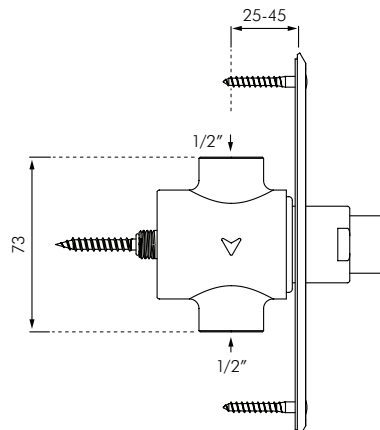

See page 5 for neck tubes for connection to urinals.

Water Guard Urinal Flushing Systems

Water Guard is primarily a water saving device that reduces water usage by at least 60% over conventional cistern tank installations. It does, however, offer the building owner complete water management and hygiene control for the urinal.

Water Guard is a microwave sensor that detects movement of people using the urinal and then initiates a flush cycle. A set of switches located inside the Water Guard give the installer/building owner various options on cycle times, flush duration and after hours flushing. The choice is made at the time of installation to suit changing needs.

The product can be used in one of three ways;

- **Using a cistern tank**

Ideal for existing installations or where very large urinals are being used. The Water Guard will automatically fill the cistern tank when the urinal is being used, but will remain dormant during after hours periods (unless switches are set for after hours flushing). Compared to conventional installations, savings of up to 60% of otherwise wasted water can be expected. Can control up to 4 solenoid valves for multi cistern tank installations.

- **Using a non potable supply tank**

Where a non potable supply is already in use, the Water Guard can control flow directly into the

urinal without the need for a cistern tank, back flow protection has already been taken care of. Offers the same flexibility in its flush options.

- **Using a Zurn Flushing Valve refer to page 9**

Installation

Installation should be as described in the installation instructions supplied with each Water Guard. The Water Guard controller is supplied with a 4 pin plug and socket for wiring to 230V AC and out to the solenoid valve. It can be surface mounted or hidden behind most ceilings (except metal foil or similar) if the ceiling is no higher than 3m. Plumbing to the Zurn flush valve and urinal should be as shown on page 9. Refer to technical data sheet for further details on switch options.

Technical Specification

Power Consumption: 10W quiescent, 30W with solenoid. 230V AC 50Hz, 3 Amps per solenoid valve.

Controller: Solid state, integrated circuit uses remotely activated doppler sensor, range up to 4m from floor, 2.5m wide.

Solenoid valve: Switch rated to 3 Amps. Pressure rated 10 - 1000kPa (Recommended 150-500kPa). Where very low heads of water are available, specify a special low pressure solenoid valve.

Water Guard

WG1 - Water Guard

SV1/240 - Solenoid Valve 1/2" BSP

SV2/240 - Solenoid Valve 3/4" BSP

- When Water Guard is to be installed in conjunction with a cistern tank, chose a solenoid valve that suits the available pipework
- Where water supplies are poor chose 3/4" valve to ensure adequate flow into cistern

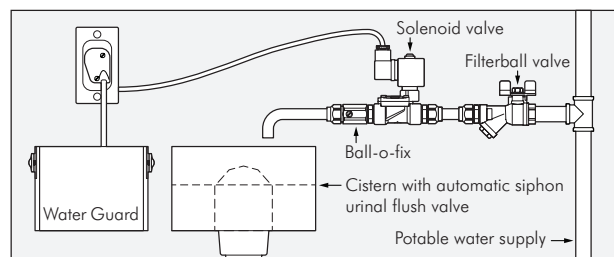

Water Guard with cistern tank

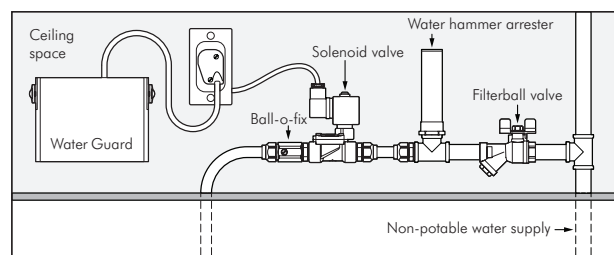

Water Guard with non potable supply



Water Guard Urinal Sensor

WG1 - Suitable for use with or without a cistern tank

- Vandal proof installation
- Adjustable cycle time (set by dip switch) allows for high or low use application
- After hours flushing ensures waste hygiene
- Simple plug system allows for easy maintenance
- High water saving compared to standard cistern tanks (at least 60%)

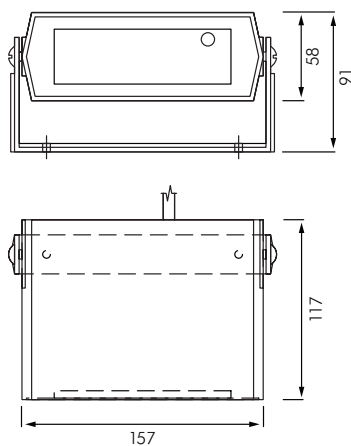

Zurn Water Guard Urinal Sensor System

Z-6190WG - Zurn Water Guard urinal system for 3-4 urinals*

- Vandal proof installation
- Adjustable cycle time (set by dip switch) allows for high or low use application.
- After hours flushing ensures waste hygiene
- Simple plug system allows for easy maintenance
- High water saving compared to standard cistern tanks (at least 60%)

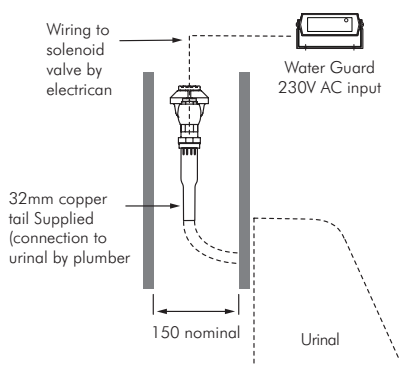

*We recommend flow control valves for multi-urinal installations to balance the flush



Delabie Neck Tubes for Urinal Valves

Delabie have developed specific additional fittings such as neck tubes that are designed to work with the Delabie urinal valves to complement the installation.

Delabie Neck Tube for Tempomatic 4 or Tempoflux Recessed Urinal Valves

DE757430

- Only suitable for use with Delabie Tempomatic 4 (Pg 5) or Tempoflux (Pg 6)
- 1/2" BSP outlet connection
- Suitable for use with urinals using flexible hose inlet connection e.g. Franke FR-CMPX538 or RAK RE-SE3100

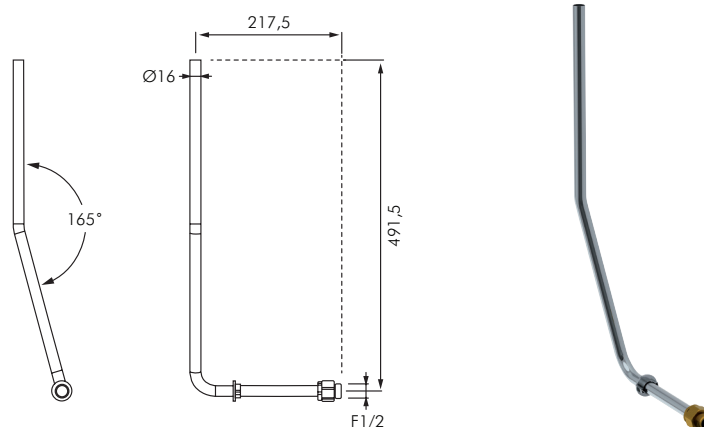

Delabie Neck Tube for Tempomatic 4 or Tempoflux Recessed Urinal Valves

DE752430

- Only suitable for use with Delabie Tempomatic 4 (Pg 5) or Tempoflux (Pg 6)
- 35mm outlet connector
- Suitable for use with urinals requiring 35mm "push on" connector e.g. RAK RA-PH3200 or RA-VE3200 urinals

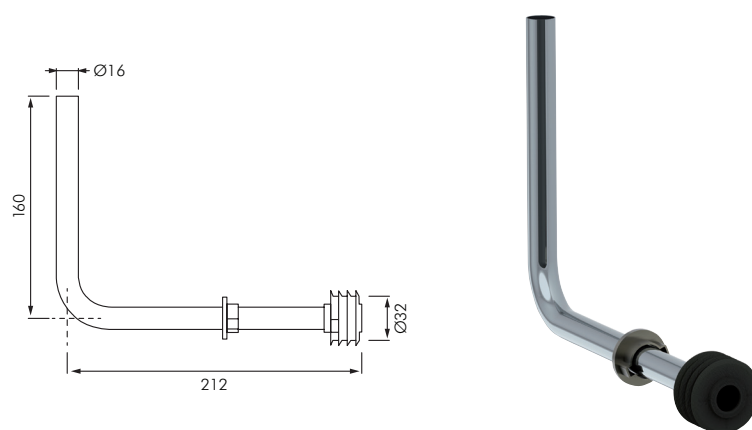

Flush Tubes

DE752000 - F1/2" 35 Ø

- Connecting tube between any Delabie exposed urinal valve and top entry MacDonald urinals

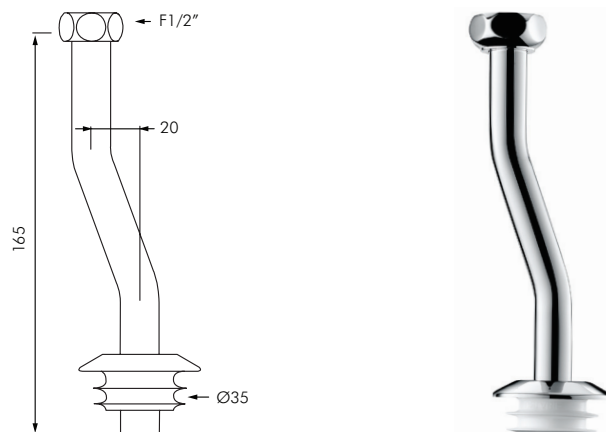

Auckland (Head Office)

20 Carr Rd, Three Kings
Auckland 1041

P: 09 624 1115

F: 09 624 1110

E: sales@macdonaldindustries.co.nz

Wellington

P: 04 569 8033

F: 04 569 8066

Christchurch

P: 03 348 2356

F: 03 348 2376

www.macdonaldindustries.co.nz