

375AST

REDUCED PRESSURE PRINCIPLE ASSEMBLY

WILKINS

APPLICATION

Designed for installation on potable water lines to protect against both backsiphonage and backpressure of contaminated water into the potable water supply. Model 375AST provides high level protection where a potential health hazard exists. Ideal for use where lead-free* valves are required.

STANDARDS COMPLIANCE (Horizontal only)

- ASSE® Listed 1013
- FM® Approved
- UL® Classified
- C-UL® Classified
- CSA® Certified
- IAPMO® Listed
- Approved by the Foundation for Cross Connection Control and Hydraulic Research at the University of Southern California
- NSF® Listed-Standard 61, Annex G*
- Certified to NSF/ANSI 372* by IAPMO R&T
- Watermark approval

*(0.25% MAX. WEIGHTED AVERAGE LEAD CONTENT)

MATERIALS

Main Valve Body	304L Stainless steel
Access covers	304L Stainless steel
Coatings	FDA Approved electrostatic epoxy finish
Internals	Stainless steel, 300 Series NORYL™, NSF Listed
Fasteners & Springs	Stainless Steel, 300 Series
Seal rings	EPDM (FDA approved)
O-rings	Buna Nitrile (FDA approved)
Sensing line	Stainless Steel, braided hose



FEATURES

Sizes	4", 6", 8", 10"
Maximum working water pressure	175 PSI
Maximum working water temperature	140°F
Hydrostatic test pressure	350 PSI

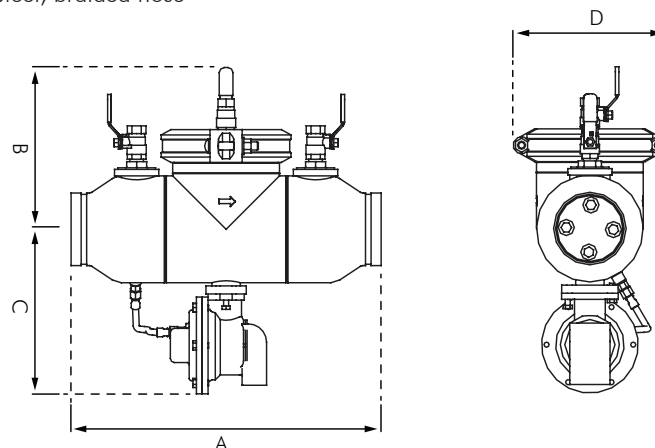

Dimension (approximate)

Size of Valve	A		B		C		D		Weight (without Gates)		Order Code
	in.	mm	in.	mm	in.	mm	in.	mm	lbs	Kg	
100mm (4")	19.24	488.7	10.10	256.5	9.75	247.7	9.50	241.3	46	21	W100 375AST
150mm (6")	23.35	593.1	11.63	295.4	10.75	273.1	12.63	320.8	73	33	W150 375AST
200mm (8")	32.20	817.9	18.50	469.9	15.63	397.0	18.00	457.2	178	81	W200 375AST
250mm (10")	31.76	806.7	18.50	469.9	15.63	397.0	18.00	457.2	178	81	W250 375AST

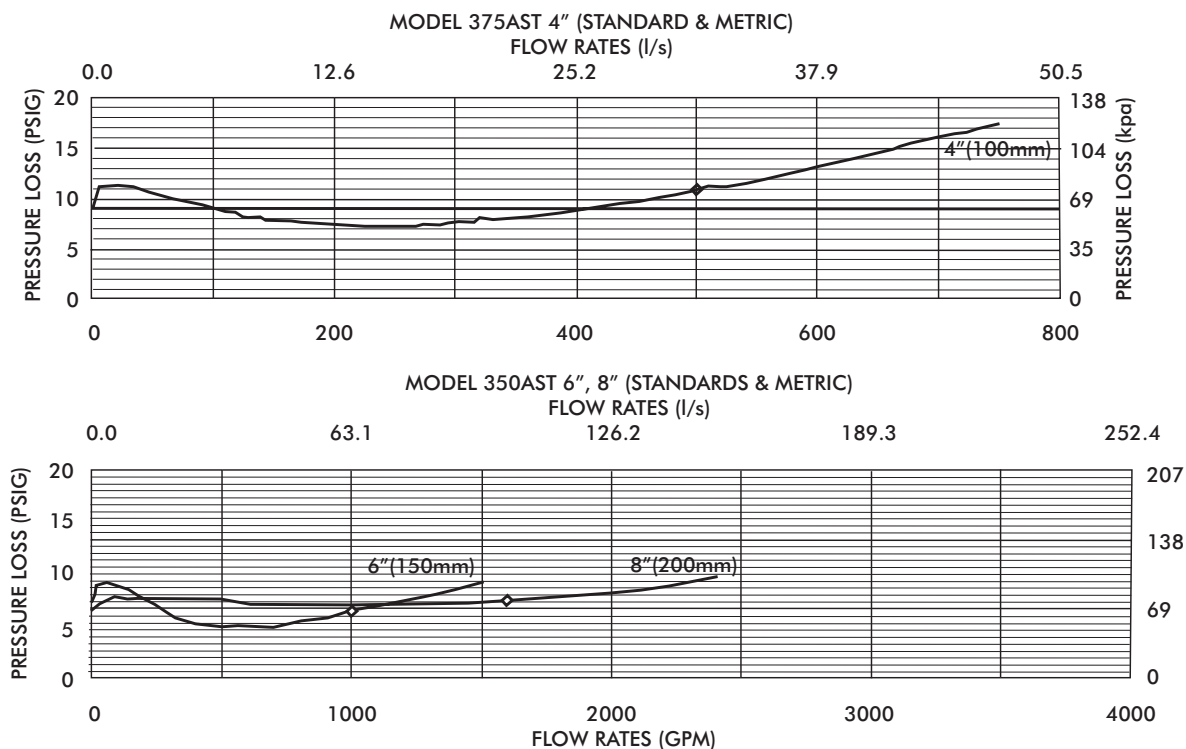

TYPICAL INSTALLATION

Local codes shall govern installation requirements. Unless otherwise specified, the assembly shall be mounted at a minimum of 12" (305mm) and a maximum of 30" (762mm) above adequate drains with sufficient side clearance for testing and maintenance. The installation shall be made so that no part of the unit can be submerged.

Capacity thru Schedule 40 Pipe (GPM)

Pipe size	5 ft/ sec	7.5 ft/ sec	10 ft/ sec	15 ft/ sec
100 (4")	198	298	397	595
150 (6")	450	675	900	1351
200 (8")	780	1169	1559	2339

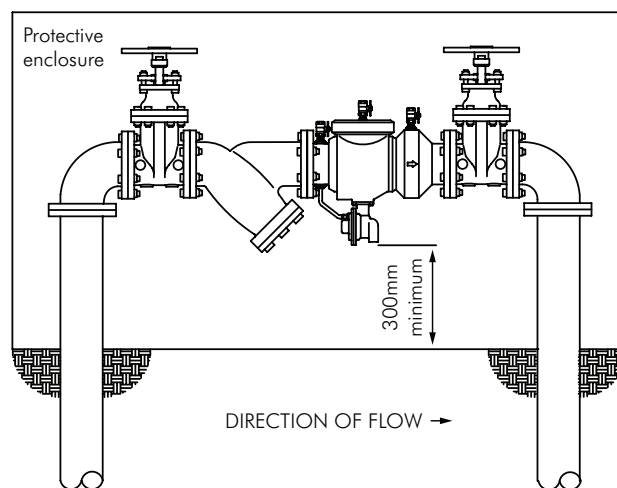

**ZURN WILKINS MODEL 375AST
OUTDOOR HORIZONTAL INSTALLATION**

SPECIFICATIONS

The Reduced Pressure Principle Backflow Prevention Assembly shall be certified to NSF/ANSI 372, ASSE® Listed 1013, and installed with full port gate valves. The main body and access cover shall be 304L Stainless Steel, the seat ring and check valve shall be NORYL™, the stem shall be stainless steel (ASTM A 276) and the seat disc elastomers shall be EPDM. The checks and the relief valve shall be accessible for maintenance without removing the device from the line. The Reduced Pressure Principle Backflow Prevention Assembly shall be a WILKINS Model 375AST.



WaterMark

Certificate No
WMK25972