

## **CM-CIST** ELECTRONIC WC CISTERN TANK



### **PACK INCLUDES**

- CM-CIST6 (6L capacity), or
- CM-CIST9 (9L capacity)
- Depending on electronic control, solenoid may be 6vDC (latching coil type), 12vDC or 24vAC
- WS1601 390 x 350 flush pipe
- WS 0349 40mm Rubber Keeseal
- Bag of 2 x fixing screws and rawl plugs
- Installation Instructions
- Guarantee Form

## INSTALLATION

- CM-CIST is suitable for use with all back to wall and wall hung WCs including Franke stainless steel and RAK ceramic.
- Cistern should be mounted to wall inside duct at a height to suit WC inlet position and flush pipe supplied. Tank has key hole fixing points on back of tank. Mark wall at 200mm spacing, drill into wall to suit fixing method. Fixing screws and rawl plugs to suit solid masonry wall supplied as standard leaving screw head approx 2mm off wall. Slip tank over screw heads.
- Cistern is pre-assembled and only requires flush pipe and inlet water connection to be fitted to complete.
- Tank lid is fitted with a 1/8" SVO solenoid valve of the appropriate voltage (6v DC, 12vDC or 24vAC) to suit the control system being installed.
- DIN connector for the solenoid should be fitted using the holding screw supplied.
- Instructions for completing wiring are supplied with the electronic controller.
- Some adjustment of the float valve inside the tank may be required to achieve maximum flush capacity.
- Maximum allowable pressure 500kPa, ideal 300kPa.

## CISTERN VALVE

Cistern valve: Part No CM-EF-ASSY.

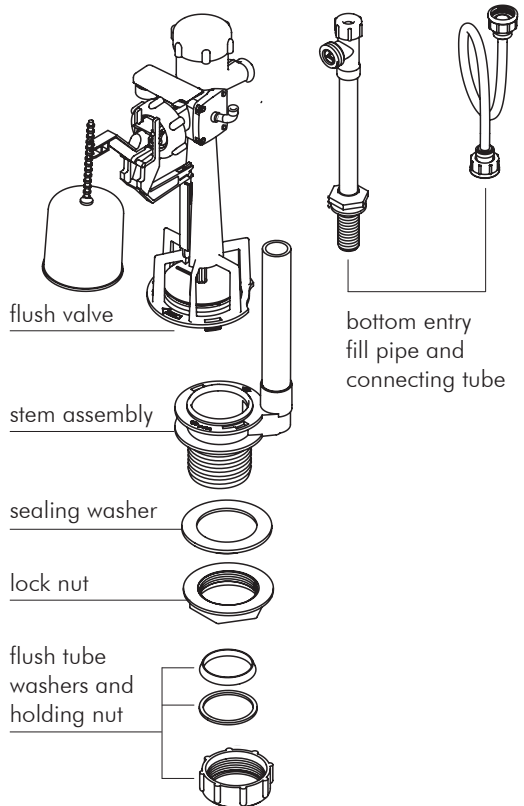

MACDONALD INDUSTRIES LIMITED  
**INSTALLATION INSTRUCTIONS**

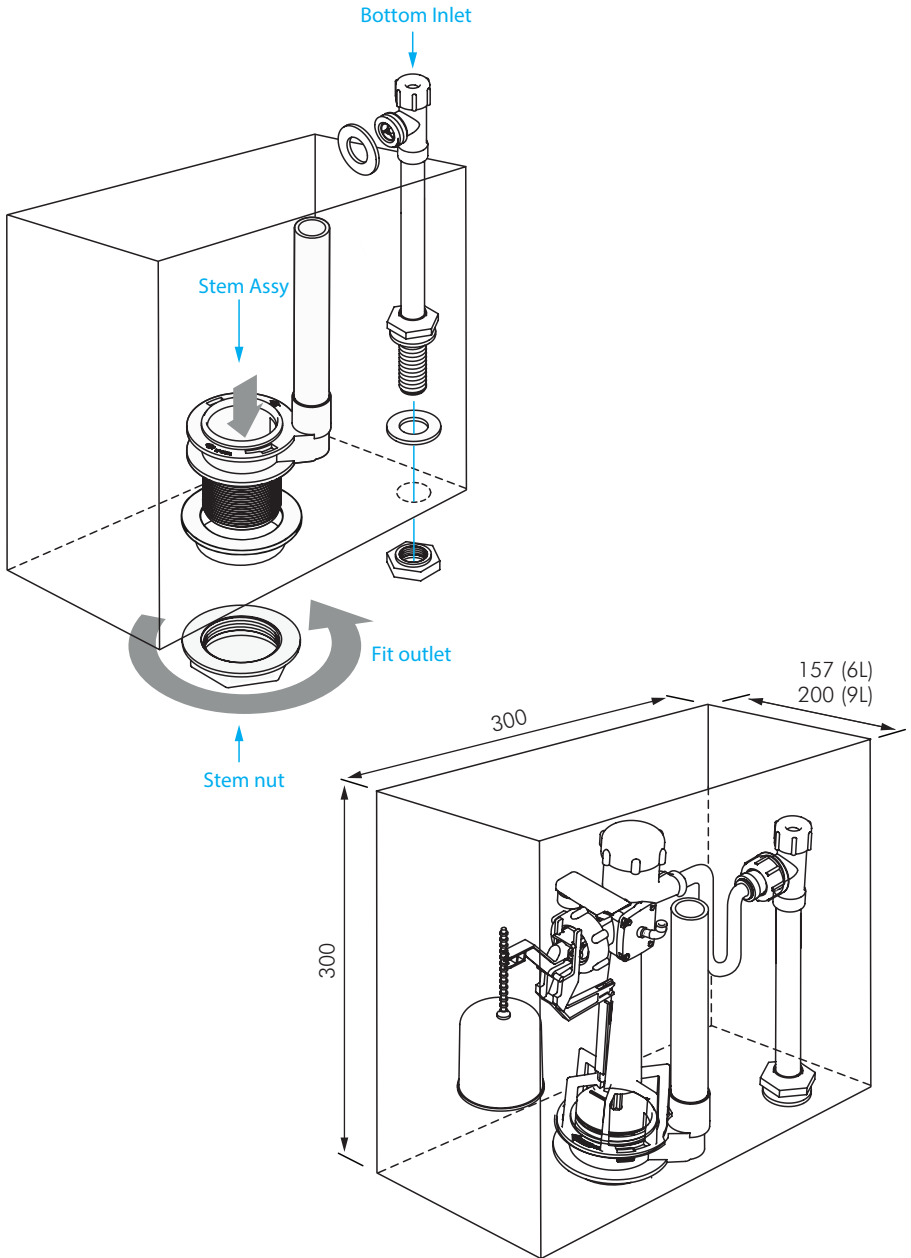



**MACDONALD  
INDUSTRIES LIMITED**

**Auckland (Head Office)**

20 Carr Rd, Three Kings

Auckland 1042

P: 09 624 1115

F: 09 624 1110

E: [sales@macdonaldindustries.co.nz](mailto:sales@macdonaldindustries.co.nz)

**Wellington**

P: 04 569 8033

F: 04 569 8066

**Christchurch**

P: 03 348 2356

F: 03 348 2376

[www.macdonaldindustries.co.nz](http://www.macdonaldindustries.co.nz)