

TEMPOMATIC 4

DELABIE

440006, 440001, 440106, 440101

Electronic Taps Deck Mounted



Tempomatic 4 deck mounted basin taps include;

Basin tap with 2 x 3/8" flexi hoses
3/8" isolators (Models 440006 & 440001 only)
3/8" x 1/2" adaptors
Installation Instructions

OPERATION

- Valve opens and closes automatically when hands are presented in the detection zone. Comfort shut-off delay is 3 seconds.
- Anti-blocking safety: a safety delay ensures the valve closes after 30 seconds in case of neglect or if an obstacle is placed in the detection field. Once the obstacle is removed the valve operation will reset automatically.
- Anti-Legionella duty flush: automatic duty flush ~ 45 seconds every 24 hours after the last use.

TECHNICAL FEATURES

- Non-return valves are integrated into the hose inlets.
- Ambient temperature for operation 7°C minimum.

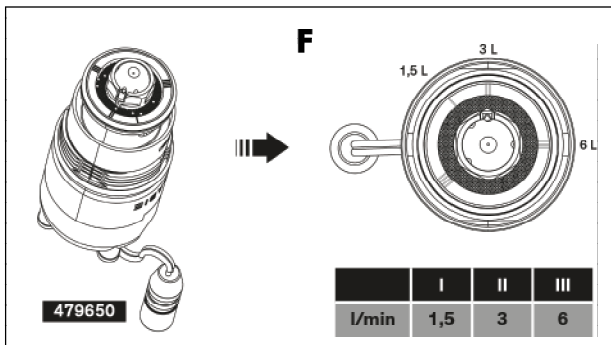
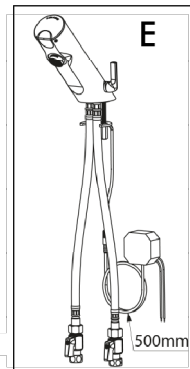
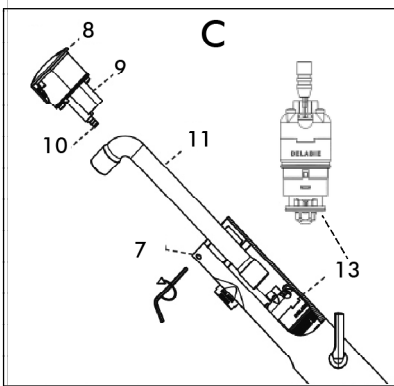
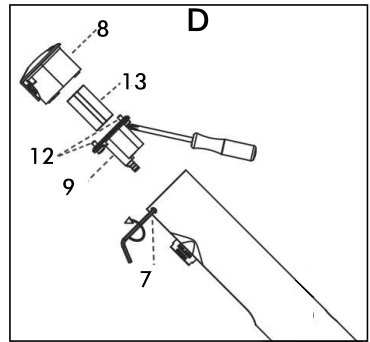
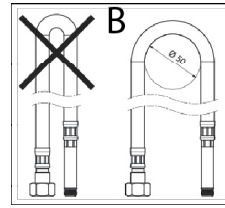
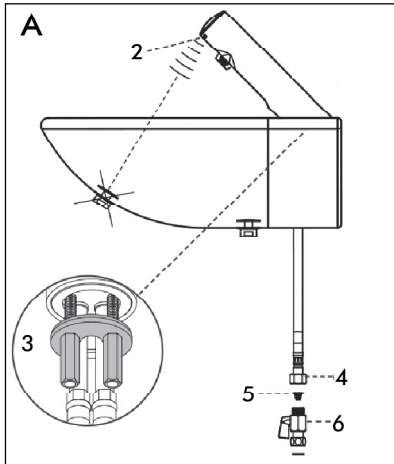

INSTALLATION

- The plug hole should be off-set from the axis of the sensor detection zone (fig. A #2) to avoid self-activation.
- **IMPORTANT:** Maximum temperature of water supplied: 55° to meet NZ requirements.
- Drill a Ø 34mm hole, mount the tap then tighten the two screws onto the fixing flange (fig. A #3). Ensure a suitable waterproof seal between the tap and the bench, appropriate to the type of installation.
- It is essential to install the filter supplied (fig. A #5), to protect the non-return valve in the tap.
- Connect the stopcock, where appropriate, (fig. A #6) to the mixed or cold water supply.
- Recommended pressure: 1 - 3 bar. Maximum pressure: 5 bar. Take care not to pinch the flexible hose (fig. B)

PREMIXED WATER

Note: In healthcare and high risk applications, a TMV3 rated thermostatic mixing valve should be installed to provide a safe mixed water temperature.

ADJUSTING THE FLOW RATE

The flow rate is pre-set at the factory at 3 l/pm (at 3 bar). To adjust the flow rate, remove the solenoid valve (dwg. D) invert the solenoid and rotate the ring to the new position (fig. F)

REMEMBER

- Our taps must be installed by professional installers in accordance with current regulations and recommendations in your country, and the specifications of the hydraulic engineer.
- Sizing the pipes correctly will avoid problems of flow rate, pressure loss and unwanted noise.
- Protect the installation with filters, water-hammer absorbers and pressure reducers to reduce the frequency of maintenance (recommended pressure: 1 to 5 bar).
- Install stopcocks close to the tap to facilitate maintenance.
- The pipework, stopcocks, bib taps and all sanitary fittings should be checked at least once a year, and more frequently if necessary.
- **Thoroughly flush the pipes to remove any impurities before installing and commissioning the mixing valve.**

MAINS POWERED MODELS

- Supplied with insulated transformer with 2 x fly leads (fig. E)
- 30mA residual circuit breaker (Type A) should be installed before the transformer
- 500mm wiring loom from faucet
- To be installed in accordance with all current NZ Electrical Regulations, with particular attention to potential moisture ingress as a result of plumbing failure and maintenance accessibility.

MAINTENANCE AND CLEANING

- **Cleaning chrome** Do not use abrasive, chlorine or acid-based cleaning products. Clean with soapy water using a cloth or a sponge.
- **Frost protection** Drain the pipes and operate the mixer several times to drain any remaining water.

MAINTENANCE

Replacing the solenoid valve:

- Shut-off the water supply.
- Deck-mounted models:
loosen the screw (fig.C #7) using a 2.5mm Allen key without removing it totally, and remove the cap (fig.C #8) by rotating slightly downwards.
- Remove the electronic sensor unit (fig. C #9) and disconnect the connector (fig. C #10).
- Using a 13mm socket (fig. C #11), unscrew the solenoid valve (fig. C #13).
- Install the new solenoid valve and carefully tighten, ensuring that the thread is not damaged.
- Reconnect the connector (fig. C #10) to the electronic unit without replacing the unit.
- Reconnect the water supply and check that the valve opens/closes by activating the electronic cell. Check that the solenoid valve is watertight inside the mixer body. If there are any leaks, gently tighten the solenoid valve.
- Replace the electronic unit and the cap.
- Carefully tighten the screw (fig. C #7).

Replacing the 6V Lithium battery:

- Low battery life (fig. D #13), will prevent the solenoid valve operating and cause the LED, (on the sensor on TEMPOMATIC 4), to blink for 15 days.
- Using a 2.5mm Allen key: loosen the screw (fig. D #7) without fully removing them and remove the cap (fig. D #8) by rotating slightly downwards.
- Remove the electronic unit (fig. D #9).
- Loosen the 2 screws (fig. D #12) to change the battery, leaving the washer in place.
- Replace the assembly, carefully tightening the screws (fig. D #7 &12) taking care not to damage the sensor.

SPARE PARTS

DE990 123 - 2 x 3V batteries
DE479 650 - solenoid valve
DE490 446 - sensor unit



**MACDONALD
INDUSTRIES LIMITED**

Auckland (Head Office)

20 Carr Rd, Three Kings
Auckland 1041
P: 09 624 1115
F: 09 624 1110
E: sales@macdonaldindustries.co.nz

Christchurch

P: 03 348 2356
F: 03 348 2376

www.macdonaldindustries.co.nz