

**DE510622**  
HIGH FLOW HAND DRYER

**DELABIE**

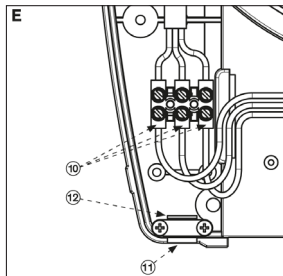
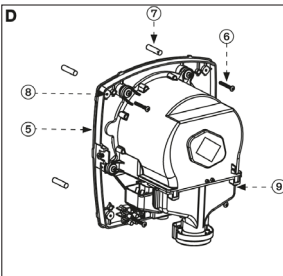
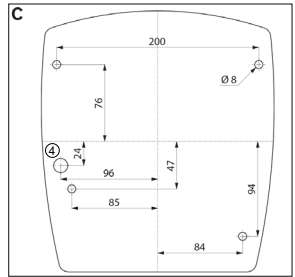
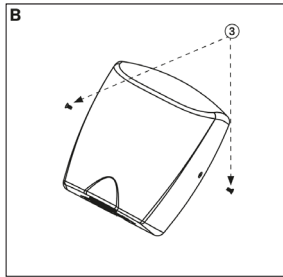
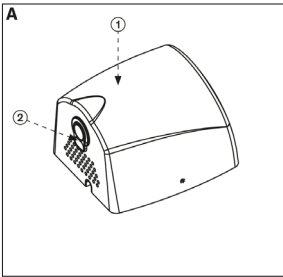

---

## OPERATION

- Position hands within 10cm of the sensor ② (**Fig. A**); hand dryer starts automatically when hands are detected.
- Stops automatically 1 second after hands are removed from the detection zone ② (**Fig. A**) or after 1 minute of continuous use.
- Electrical supply: 1350W, 220-240V~ / 50-60 Hz.

## INSTALLATION

- Electrical supply 220 - 240V~ / 50-60Hz class I (with earth).
- The installation must conform to current local regulations in your country.
- IP23 waterproof, electronic control unit.
- The hand dryer must be fitted with residual current circuit breaker with 6A overload protection and 30mA trip current. The hand dryer must be earthed (see ELECTRICAL CONNECTION section).
- Unscrew the 2 side screws ③ (**Fig. B**) and remove the cover ① (**Fig. A**).
- Using the template provided (**Fig. C**), drill 4 holes Ø 8mm and 1 hole for cable entry if required ④. Add the shock absorbers ⑥ to the back of the base plate ⑤. Fix the base plate ⑤ to the wall using screws and rawl plugs ⑥, ⑦ (**Fig. D**) provided. Ensure screws and rawl plugs are suitable for the type of wall material. Recommended installation height (distance between the floor and the bottom of the dryer): 120cm for men, 110cm for women, 80-100cm for wheelchair users, and 95cm for children.
- In the default setting, the hand dryer will deliver hot air. To change to cold air, place the switch ⑨ (**Fig. D**) in position 0.
- Replace the cover ① (**Fig. A**) and tighten the 2 side screws ③ (**Fig. B**).

## ELECTRICAL CONNECTION

Electrical connection should be completed before dryer is mounted to wall.

- For a concealed electrical connection use AS/NZS5000.2 compliant TPS cable, feeding through hole in base plate ④.
- Connect the wires to connectors L, N and GND (GND = earth) tighten connector screws ⑩ onto the terminals. Tighten the retaining clip screws ⑪ to secure the power supply cable ⑩ (**Fig. E**) if a non-concealed electrical connection is used.
- Replace the cover ① (**Fig. A**) and tighten the 2 side screws ③ (**Fig. B**).

## **REMEMBER**

- Installation must only be completed by a registered electrician in accordance with local regulations.
- Avoid splashing the inside the hand dryer mechanism.
- Do not install the hand dryer next to a bath, shower or washbasin.
- Do not shake the hand dryer.
- Do not block the sensor or the air outlet.
- If the hand dryer malfunctions, immediately disconnect the power supply and contact our Technical Support team.
- Do not install the hand dryer outside.

## **MAINTENANCE & CLEANING**

Clean with mild soapy water using a damp cloth. Do not use scouring powder, abrasive, chlorine, alcohol or acid-based cleaning products.



**MACDONALD  
INDUSTRIES LIMITED**

**Auckland (Head Office)**

20 Carr Rd, Three Kings  
Auckland 1041  
09 624 1115  
sales@macdonaldindustries.co.nz  
macdonaldindustries.co.nz

**Christchurch**

32B Hayton Road  
Wigram, Christchurch  
03 348 2356  
christchurch@macdonaldindustries.co.nz

**Wellington**

04 569 8033