

DELABIE - DE714 700
SPORTING 2 SHOWER PANEL

DELABIE

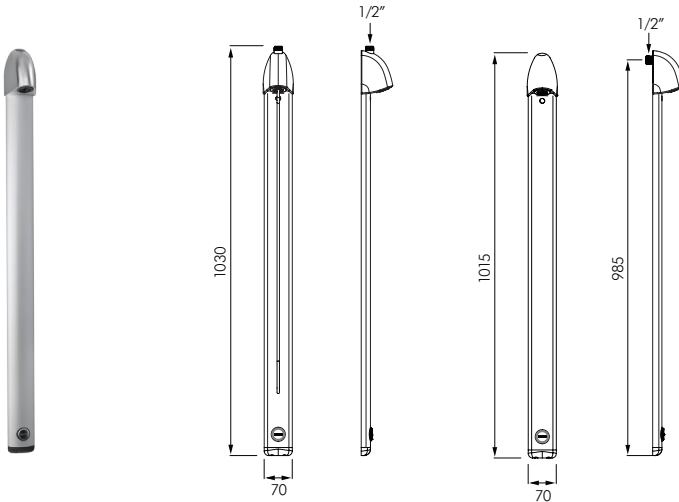

**SHOWER PANELS AND SHOWER KITS
WITH AUTOMATIC, TIME FLOW SHUT-OFF**

Thoroughly flush the pipes to remove any impurities before installing and commissioning the product.

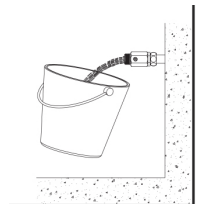

MACDONALD INDUSTRIES LIMITED
INSTALLATION INSTRUCTIONS

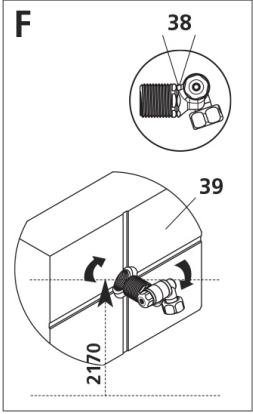
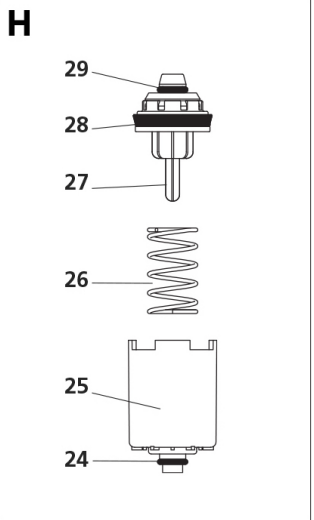
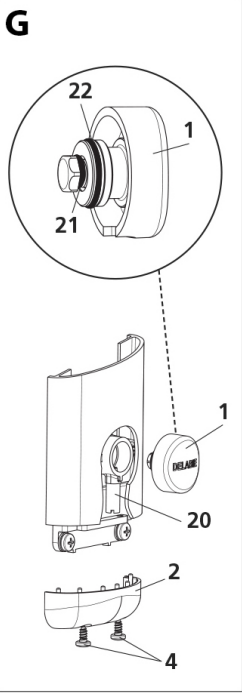
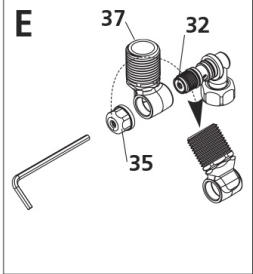
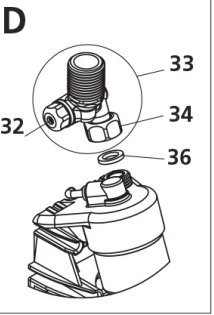
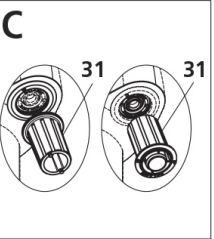
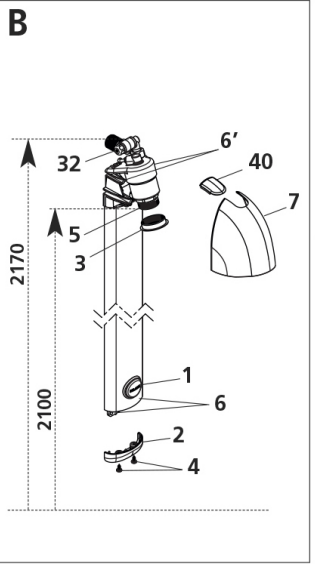
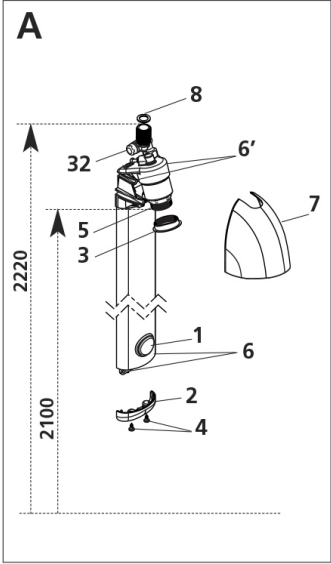

MACDONALD INDUSTRIES LIMITED
INSTALLATION INSTRUCTIONS

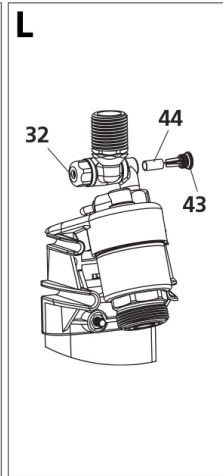
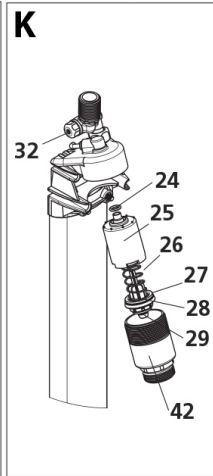
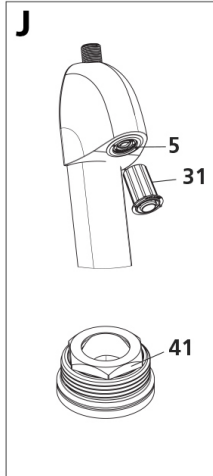
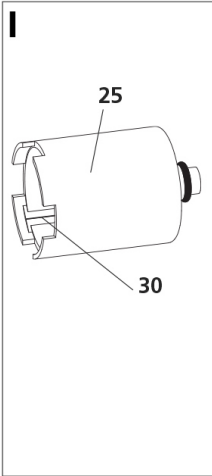

OPERATION

- Press the push-button starter 1 (Fig. A, B) to open the valve.
- Automatic shut-off after ~30 seconds (+5/-10).

INSTALLATION

In order to capture all of the spray, install the shower tray 10cm from the wall: we recommend recessed shower trays or sloping gutters. If a small, raised shower tray is installed, the shower nozzle can be replaced with a grid (Ref. GR) to concentrate the jet.

SPORTING shower panel with top inlet (Fig. A, C)

- Position the panel so that the shower nozzle **5** is 2.10m from the floor.
- Using the tool **31** (supplied) or a pair of circlip pliers unscrew the ring **3** and remove the cover **7**.
- Unscrew the 2 screws **4** using a Phillips screwdriver and remove the end-cap **2**.
- Mark and drill the 4 holes **6** and **6'**.
- Fix the panel in place using the **4** screws supplied (use rawl plugs that are suitable for the wall material).
- Install the washer **8** (supplied) and connect to the mixed water supply (we recommend installing a thermostatic mixing valve upstream).
- Using a 3mm Allen key (not supplied), check that the stopcock **32** is wide open (anti-clockwise).
- Supply with water and check for leaks.
- Replace the cover **7** and tighten up the ring **3** using the tool **31** or a pair of circlip pliers.
- Replace the end cap **2** and tighten the 2 screws **4**.



SPORTING shower panel with back inlet (Fig. B, C, D, E, F)

- Position the panel so that the shower nozzle **5** is 2.10m from the floor (or the water supply is 2.17m above the ground) (Fig. B).
- Using the tool **31** (supplied) or a pair of circlip pliers, unscrew the ring **3** and remove the cover **7** (Fig. B, C).
- Remove the inlet assembly **33** by unscrewing nut **34** using a 19mm spanner (not supplied) (Fig. D).
- Close the stopcock **32** (clockwise) using a 3mm Allen key (not supplied) (Fig. E).
- Do not lose the washer **36** (Fig. D).
- Fully unscrew nut **35** with a 14mm spanner (not supplied) (Fig. E).
- Turn the threaded screw **37** and nut **35** (Fig. E).
- Connect the mixed water supply (we recommend installing a thermostatic mixing valve upstream) by screwing the threaded screw **37** into the wall fitting, making sure that the threaded part has a waterproof seal. Tighten so that the groove **38** is in line with the mounting surface **39** (Fig. F).
- Using a 3mm Allen key (not supplied), check that the stopcock is closed (clockwise), open the water supply and check for leaks.
- Use a Phillips screwdriver to unscrew the two screws **4** and the end cap **2** (Fig. B).
- Position the panel, insert washer **36** and tighten nut **34** (Fig. D).
- Mark and drill the 4 holes **6** and **6'** (Fig. B).
- Fix the panel in place using the 4 screws supplied (use rawl plugs that are suitable for the wall material).
- Connect the water supply and check that there are no leaks.
- Open the stopcock **32** (anti-clockwise) using a 3mm Allen key (Fig. E).
- Slide the cap **40** into the slot on the cover **7** (Fig. B).
- Replace the cover **7** and tighten up the ring **3** using the tool **31** (supplied) or a pair of circlip pliers (Fig. B, C).
- Replace the end-cap **2**, tighten the 2 screws **4** (Fig. B).

IT IS THE INSTALLER'S RESPONSIBILITY TO:

- ENSURE THAT THE RECESSED AREA IS WATERTIGHT TO PREVENT ANY WATER INGRESS.
- GUARD AGAINST THE ACCIDENTAL PRESENCE OF WATER IN THE RECESSED AREA AND ENSURE THAT THERE IS NO WATER STAGNATION AND THAT ANY WATER (CONDENSATION, RUN-OFF, LEAKAGE, ETC.) DRAINS AWAY.
- ENSURE THAT THE SEALS/JOINTS BETWEEN THE WALL PLATE AND THE BODY OF THE MIXER ARE CHECKED REGULARLY (AT LEAST ONCE A YEAR) AND REPLACE THE SEALS/WASHERS IF NECESSARY.

Failure to comply with this advice may lead to leakage into the wall, for which MacDonald Industries cannot be held responsible.

IF IN DOUBT, CONTACT TECHNICAL SUPPORT.



COMMISSIONING (FIG. A, B)

- Press the starter **1** repeatedly to purge the air until the automatic shut-off stabilises (~ 30 sec. +5/-10): the first cycles can last 5-7 minutes. Pressing on the starter **1**, releases a jet of water beneath the panel. This causes the shower to open hydraulically. Releasing the starter will stop the jet of water.

SETTINGS (FIG. A, B, C, J)

- The water jet from the nozzle **5** can be rotated through 20°. Apply pressure with your thumb on the nozzle **5** and adjust to the desired position.
- The rotational position can be locked in place. To do this:
 - Remove the nozzle **5** using the tool **31** (supplied) or a pair of circlip pliers (**Fig. J**).
 - Using a 19mm spanner (not supplied), carefully tighten the nut **41**.
 - Replace the nozzle **5**, taking care not to block it.
- The flow rate can be adjusted:
 - Unscrew the ring **3** using the tool **31** (supplied) or a pair of circlip pliers, and remove the cover **7**. Turn the screw **32** using a 3mm Allen key. Once the flow rate has been adjusted, replace the cover **7** and the ring **3** using the tool **31** supplied or a pair of circlip pliers (**Fig A, B, C**).

REMEMBER

- **Our mixers/taps must be installed by professional installers** in accordance with current regulations and recommendations in your country, and the specifications of the hydraulic engineer.
- **Sizing the pipes correctly** will avoid problems of pressure loss and unwanted noise.
- **Protect the installation** with filters, water hammer absorbers and pressure reducers to reduce the frequency of maintenance. (Recommended pressure: 1.5 to 5 bar).
- **Install stopcocks** close to the mixer to facilitate maintenance.
- The pipework, stopcocks, mixers and all sanitary ware must be checked regularly, and at least once a year.



MAINTENANCE

SPORTING panel

Dirt or abrasions on the O-rings on the starter (Fig. A, B, C, G):

- Using the tool **31** unscrew the ring **3** and remove the cover **7** (Fig. A & C or B & C).
- Turn off the water supply by closing the stopcock **32** (clockwise) (Fig. A or B).
- Unscrew the two screws **4** and remove the end cap **2** (Fig. A or B).
- Remove the starter, partially loosening the holding screw **20** with a screwdriver (not supplied) (Fig. G).
- Remove the ring using a flat screwdriver, applying pressure to eject the starter. (Fig. G).
- Check/clean the O-rings **21** and **22** (Fig. G).
- Replace the starter and the ring: press fully on the starter then release; tighten the screw **20**.
- Open the water supply by opening the stopcock **32** (anti-clockwise) (Fig. A or B).
- Replace the cover **7** and tighten the ring **3** using the tool **31** or a pair of circlip pliers (Fig. A & C or B & C).
- Replace the end cap **2** and tighten the two screws **4** (Fig. A or B).

Dirt or abrasions on the O-rings on the shower head mechanism (Fig. A, B, C, H, I, K):

- Using the tool **31** or a pair of circlip pliers, unscrew the ring **3** and remove the cover **7** (Fig. A & C or B & C).
- Turn off the water supply by closing the stopcock **32** (clockwise) (Fig. A or B).
- Using a 30mm spanner, unscrew the mechanism body **42** (Fig. K).
- Remove the delay case **25**, the spring **26** and the piston **27**, taking care not to lose the washer **24** (Fig. H).
- Clean the inside of the delay case **25** with a cloth, and the timing groove **30** with a non-metallic point, and check/clean the seals **28** and **29** (Fig. H, I).
- Replace the mechanism assembly not forgetting the washer **24** (Fig. H).
- Restore the water supply by opening the stopcock **32** (anti-clockwise) (Fig. A or B).
- Replace the cover **7** and tighten the ring **3** (Fig. A or B).

Cleaning the filter (Fig. A, B, C, L):

- Using the tool **31** or a pair of circlip pliers, unscrew the ring **3** and remove the cover **7** (Fig. A & C or B & C).
- Turn off the water supply by closing the stopcock **32** (clockwise) using a 3mm Allen key (not supplied) (Fig. A or B).
- With the same Allen key, unscrew the filter holder **43** and clean the filter **44** (Fig. L).
- Replace the filter **44** and the filter holder **43**.
- Restore the water supply by opening the stopcock **32** (anti-clockwise) (Fig. A or B).
- Replace the cover **7** and tighten the ring **3** using the tool **31** or a pair of circlip pliers (Fig. A or B).

Frost protection (Fig. A, B, C):

- Shut off the mains water supply or the stopcock near the installed SPORTING shower.
- To drain the SPORTING panel, operate to reduce the pressure.
- Remove SPORTING panel:
 - Using the tool **31** or a pair of circlip pliers, unscrew the ring **3** and remove the cover **7** (Fig. A & C or B & C).
 - Use a Phillips screwdriver to unscrew the two screws **4** and remove the end cap **2** (Fig. A, B).
 - Remove the four screws **6** and **6'** (Fig. A, B).
 - Remove SPORTING panel and store it in a frost-free area.





**MACDONALD
INDUSTRIES LIMITED**

Auckland (Head Office)

20 Carr Rd, Three Kings

Auckland 1041

P: 09 624 1115

F: 09 624 1110

E: sales@macdonaldindustries.co.nz

Wellington

P: 04 569 8033

F: 04 569 8066

Christchurch

P: 03 348 2356

F: 03 348 2376

www.macdonaldindustries.co.nz