



## Timed flow basin mixers and taps with smooth activation

- Smooth activation (children, handicapped or elderly people)
- Flow-rate regulated to 4 l./min (740000 et 741000) or 6 l./min (742000), water savings about 70%
- High resistance to vandalism
- Scale & corrosion-proof mechanism, resistance >500 000 uses



Ref : 740000



Ref : 741000

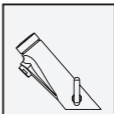

Ref : 742000

## TEMPOSOFT MIXERS AND TAPS :

• **Smooth activation :**

Timed flow cartridge about 15 sec. with depression activation, operatable by children, handicaped or elderly people. Use : public and commercial place and particularly hospitals, day nurseries, schools...

• **Flow-rate pre-set at 4 or 6 l./min.**, adjustable according to network pressure, from 1 to 5 bar, **water savings about 70%**.• **High resistance to vandalism**, body in chrome-plated heavy brass: specifically designed for intensive use in public and commercial places.• **Reliability** : scale and corrosion-proof mechanism, scale-proof aerator.

---

**742000 TEMPOSOFT timed flow push basin mixer :**

- Side temperature selector.
- Stainless steel flexible connectors with non-return valves.
- Reinforced fixing.

**740000 TEMPOSOFT timed flow push basin tap :**

- Reinforced fixing by 3 stainless steel screws.
- Spout H.65, L.102.

**741000 TEMPOSOFT timed flow push basin bib tap :**

- M1/2" connection.
- L.80.

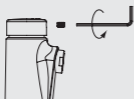

**fig. 1**

Unscrew the button screw with a 2,5 Allen key



**fig. 2**

Remove the push-button

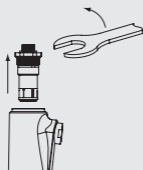

28 mm

**fig. 3**

Unscrew the cartridge with a 28 mm. spanner key

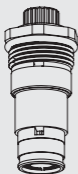

Flow  
limitation  
ring

Seat washer

**fig. 4**

**Flow-rate adjustment :**

- Remove the seat washer under the flow limitation ring.
- Remove the ring by dragging it, then replace it by lining up the outlet with the mark corresponding to the network pressure: I for 5 bar, II for 3 bar and III for 1 bar.

**INSTALLATION**

- **Drain** thoroughly supply pipes before connecting the tap.
  - Adjust the flow-rate as shown in opposite illustrations.
  - Activate several times the tap in order to obtain the normal shut-off delay.
- Pressure : 0,5 up to 5 bar.
- For mixed water supply, please use a PREMIX mixing valve.

**FLOW RATE ADJUSTMENT**

- Pre-set at 4 or 6 l./min. for a 3 bar pressure**, it is recommended to adjust the cartridge according to the network pressure.
- Unscrew the button with a 2,5 Allen key (fig. 1).
  - Remove push-button (fig.2)
  - Unscrew cartridge with a 28 mm.spanner key (fig.3).
  - Flow-rate adjustment (fig.4)
    - Remove the seat washer under the flow limitation ring.
    - Remove the ring by dragging it, then replace it by lining up the outlet with the mark corresponding to the network pressure: I for 5 bar, II for 3 bar and III for 1 bar.

**IMPORTANT :**

- **Check pipe sizing** to avoid water hammer, pressure and flow rate losses.
- **Protect hydraulic installation** by general filters and pressure regulator in order to reduce maintenance frequency.
- **A service valve** should be fitted in close proximity to sanitary taps to simplify maintenance.

## Mitigeur TEMPOSOFT

- **Installation :**

- Fit **as shown on the drawing** (fig.7) the supplied filters in order to protect non-return valves.
- Inlet maintained pressure : 0,5 to 5 bar
- Balance CW and HW pressures :  $\text{diff.P} < 1 \text{ bar}$

- **Maximum temperature adjustment :** ( see fig.5 + fig.6)

- Unscrew back screw with a 4 mm hexagonal key.
- Pull out the side temperature selector lever.
- Pull out the badge (P) from hole (T) in order to admit cold water flow, when selector is in maximum temperature level.

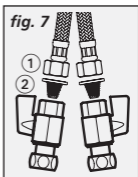
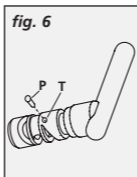
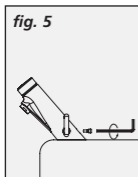

## CLEANING &amp; SERVICING

- Chrome cleaning

The plated chrome must only be cleaned with mild soap and water, with a soft cloth. **DO NOT USE ABRASIVE** or chlorin cleaners.

- Risk of freezing

The installation is not protected against freezing : the pipes must be bled before winter by pressing several times on the push-button in order to flush out them. If the installation remains unused for a long time, the best way is to remove the complete cartridge containing the mechanism and to store it in a cool room.

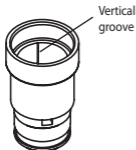

## MAINTENANCE

In the unlikely event that the flow/timer mechanism gives cause for concern (dirts coming from supply pipes, ...) interchangeable cartridge is available.

To remove the mechanism, unscrew the cartridge with a 23 mm A.F. spanner (see fig. 3).

- In case of no shut off, or too long shut-off delay : clean the delay case with a dry cloth. Clean the vertical groove with a knife.
- In case of Drip or leak : clean the seat washer or replace it if it is damaged.

Attention : never grease the internal mechanism.