

RA-CO1144/1145
COMPACT ACCESSIBLE
WALL FACED TOILET PAN

RAK
CERAMICS



PACK INCLUDES

- RA-CO11400P back to wall toilet
- RA-CO145400 soft close Urea seat & lid (Model RA-CO1144)
- RA-CO145500 Care seat only (Model RA-CO1145)
- Fixing kit ref RA-FS37UK
- Installation Instructions
- Guarantee Form

NOTE:

Only RA-CO1144 complies with AS1428.1:2009 requirements for use in a disabled bathroom

NOTES

- Inspect all items thoroughly immediately on receipt to ensure it meets your requirements.
- Inspect product for defects prior to installation. MacDonald Industries will not be responsible for any claims related to replacements after a product has been installed.
- Ensure floor on which toilet is to be installed is level and of a suitable material for installation of a toilet.
- Check water pressure does not exceed 500kPa. Fit pressure reducing valve if necessary.
- Check water inlet / waste outlet positions are correct for the toilet supplied according to the measurements in Dia. 1.
- All measurements provided are based on finished wall/floor.
- Installation must only be completed by a registered plumber in accordance with AS/NZS3500 requirements.
- Only fix toilet's through floor mounting brackets supplied. **NEVER** attempt to fix through back wall.
- Where floor is sloped bed the toilet using a sand and cement mixture or proprietary levelling compound.

INSTALLATION

- Position toilet onto pan connector checking that it fits tight to the back wall and floor.
- Mark the position of fixing brackets on the floor and then remove toilet. **Do not use fixing holes as a guide for drilling as damage may occur.**
- Drill holes into floor as per Dia. 2 and fix mounting brackets.
- Ensure floor is clean of dirt, dust or impurities.
- Re-fit toilet securing it to the mounting brackets using sleeves/screws supplied.
- Ensure toilet has fitted correctly to inlet water pipe and waste outlet and check pan for level.
- Fit chrome screw caps supplied.
- Apply a bead of flexible mould resistant silicon around base of pan.

On completion of installation, flush lines of any debris and then connect supply to valves.

If toilet is installed in conjunction with a flushing valve, remove internal components of the flush valve according to manufacturers recommendation, then open stop cock to flush debris/air for at least 1 minute. Reassemble flush valve at test flush.

MACDONALD INDUSTRIES LIMITED
INSTALLATION INSTRUCTIONS

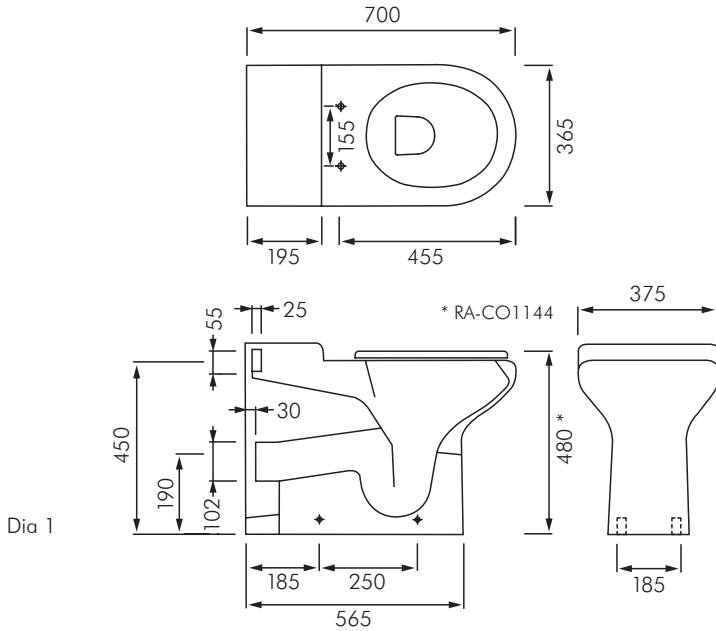

Dia 1

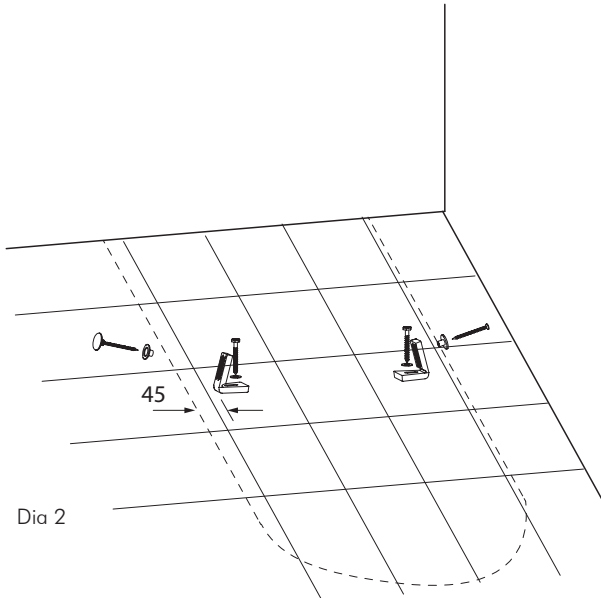

Dia 2

SPARES

- Toilet fixing kit - RA-FS37UK
- Soft close urea seat fixing kit - RA-CO1454HN



**MACDONALD
INDUSTRIES LIMITED**

Auckland (Head Office)

20 Carr Rd, Three Kings

Auckland 1041

P: 09 624 1115

F: 09 624 1110

E: sales@macdonaldindustries.co.nz

Wellington

P: 04 569 8033

F: 04 569 8066

Christchurch

P: 03 348 2356

F: 03 348 2376

www.macdonaldindustries.co.nz