

---

## INSTALLATION CISTERN TANK

- Cistern attaches to wall using a metal retaining plate and fixing screws.
- Fit flush pipe to cistern and pan using pan connector supplied. Trim length of flush pipe to suit pan distance from the wall.
- All RAK cisterns use Geberit fill and flush valves. Each cistern has specific Geberit instructions contained within the cistern. The inlet valve is located on the right hand side underneath the cistern tank but can be shifted to the other side of the cistern if preferred.
- Disconnect water supply to cistern and flush line thoroughly to ensure no debris enters fill valve.
- Reconnect water and check flush.
- Each cistern is factory set to deliver a 6/3L flush. Flush volume can be adjusted by rotating the level screw on the inlet fill valve.

## SPARES

- Cistern fill valve
  - Bottom inlet - RA-FS68I
- Cistern flush valve - RA-FS68F
- Toilet fixing kit - RA-FS37UK



**MACDONALD  
INDUSTRIES LIMITED**

### **Auckland (Head Office)**

20 Carr Rd, Three Kings  
Auckland 1041  
09 624 1115  
sales@macdonaldindustries.co.nz  
www.macdonaldindustries.co.nz

### **Christchurch**

03 348 2356  
christchurch@macdonaldindustries.co.nz

### **Wellington**

04 569 8033

**RA-LE1513 / 1515**  
LENA CHILD LINK TOILET SUITE

---

**RAK**  
CERAMICS



**PACK INCLUDES**

- RA-LE15100S link suite toilet
- RA-LE165000 wall mounted cistern tank
- RA-JU145300 seat and lid (Model RA-LE1513)
- SA56.049 seat only (Model RA-LE1515)
- Fixing kit ref RA-FS37UK
- Installation instructions
- Warrantee form

## NOTES

- Inspect all items thoroughly immediately on receipt to ensure it meets your requirements.
- Inspect product for defects prior to installation. MacDonald Industries will not be responsible for any claims related to replacements after a product has been installed.
- Ensure floor on which toilet is to be installed is level and of a suitable material for installation of a toilet.
- Check water pressure does not exceed 500kPa. Fit pressure reducing valve if necessary.
- Check water inlet/ waste outlet positions are correct for the toilet supplied according to the measurements in Dia. 1.
- All measurements provided are based on finished wall/floor.
- Installation must only be completed by a registered plumber in accordance with AS/NZS3500 requirements.
- Only fix Toilet's through floor mounting brackets supplied.
- Where floor is sloped bed the toilet using a sand and cement mixture or proprietary levelling compound.

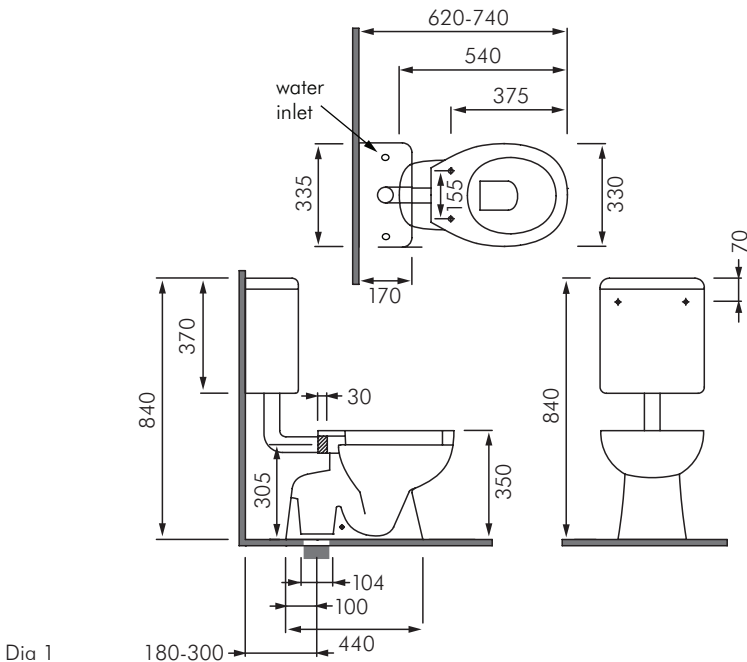

## **INSTALLATION TOILET PAN**

- Position toilet onto pan connector checking that pan is square to walls.
- Mark the position of fixing brackets on the floor and then remove toilet. **Do not use fixing holes as a guide for drilling as damage may occur.**
- Drill holes into floor as per Dia. 2 and fix mounting brackets.
- Ensure floor is clean of dirt, dust or impurities.
- Re-fit toilet securing it to the mounting brackets using sleeves/screws supplied.
- Fit chrome screw caps supplied.
- Apply a bead of flexible mould resistant silicon around base of pan.

