

DELABIE

TEMPOMATIC 4

DE4300xx

EN

Electronic urinal valve in a waterproof housing



Thoroughly flush the pipes to remove any impurities before installing and commissioning the product.

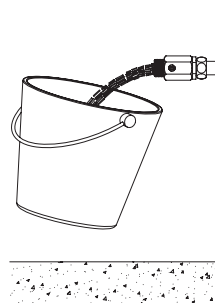

430PBOX - 430SBOX

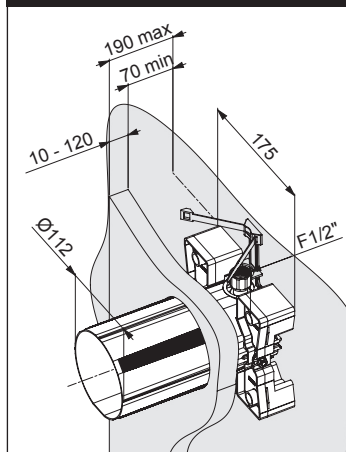

431PBOX - 431SBOX

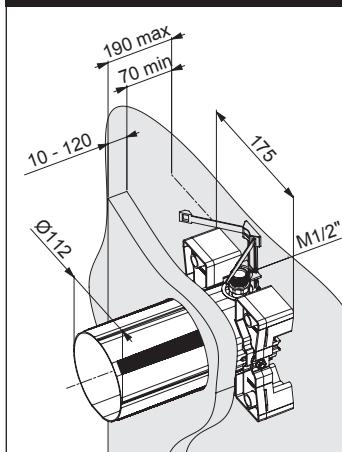

430000 - 430006 - 430010 430016 - 430020 - 430026 430030 - 430036

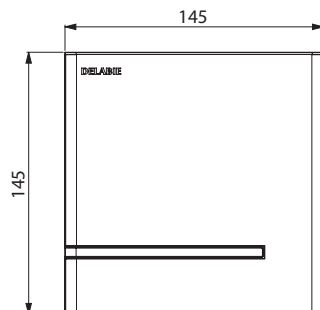

430PBOX - 430SBOX 431PBOX - 431SBOX

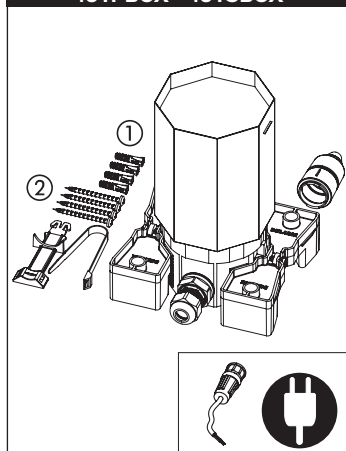

430000 - 430006 - 430010 430016 - 430020 - 430026

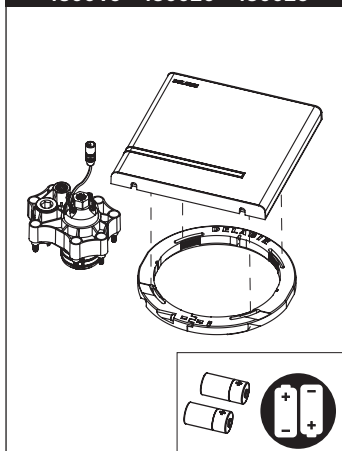

430030 - 430036

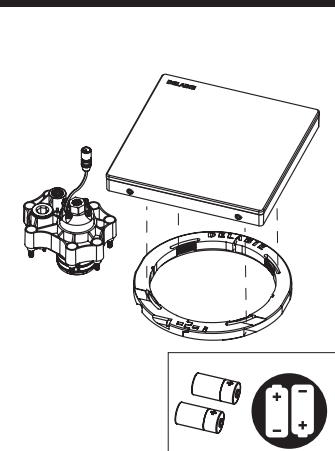

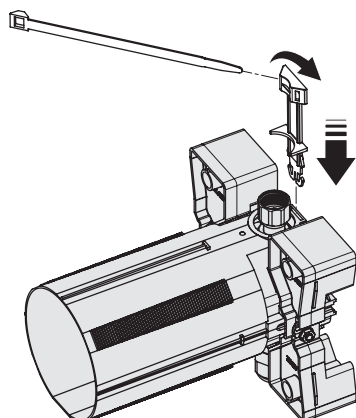

A

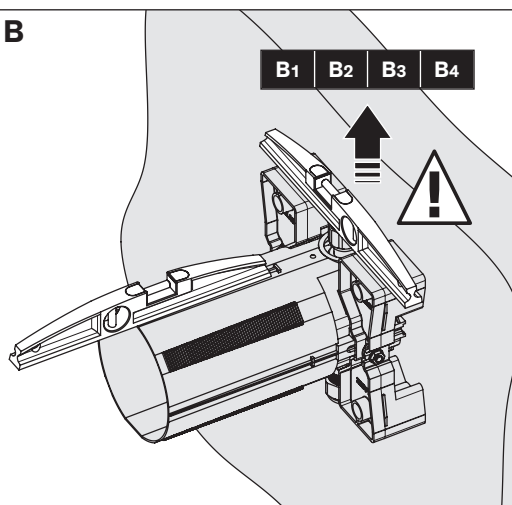

B



- ① 
- ② 

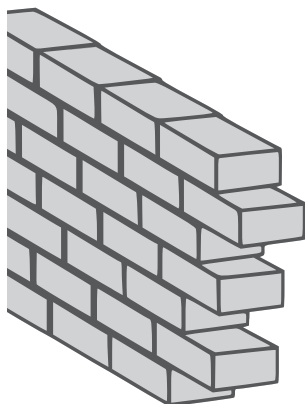

B1

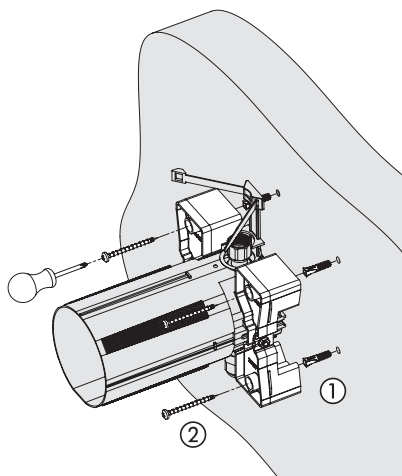

B2

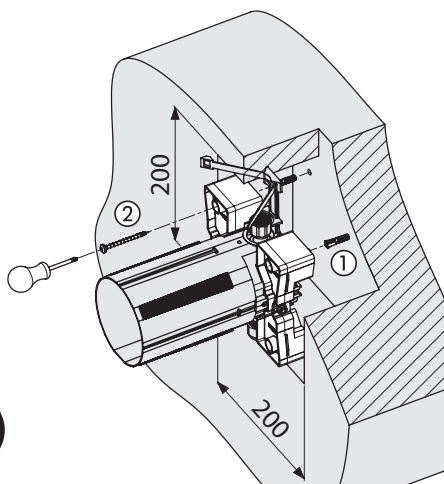

B3

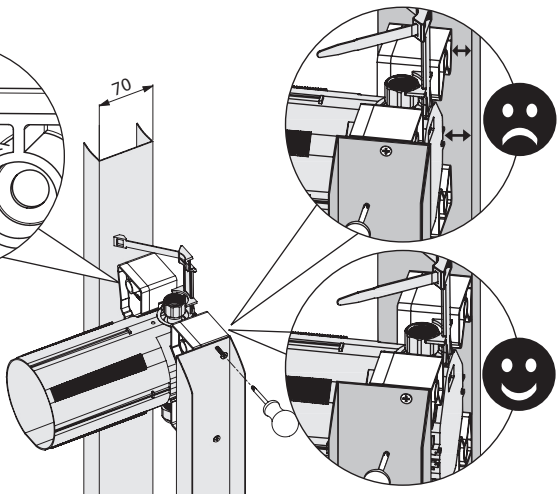
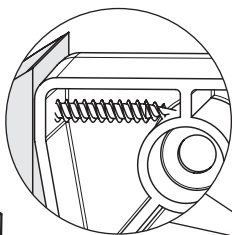
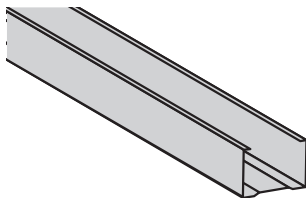

B4

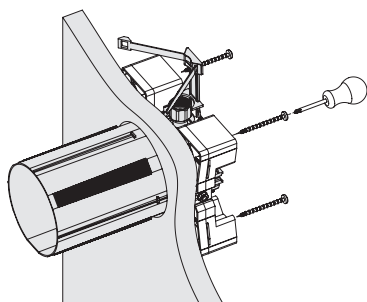

> 25

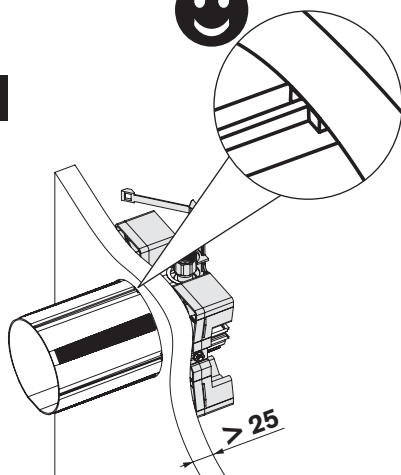

< 25

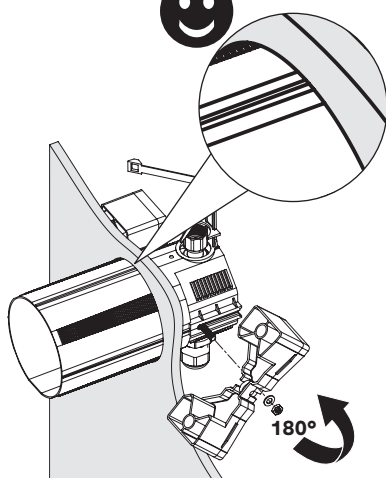
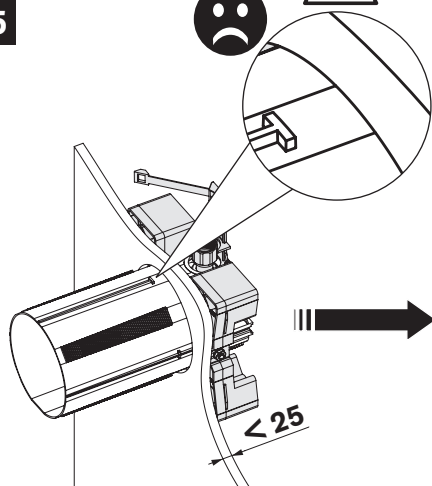

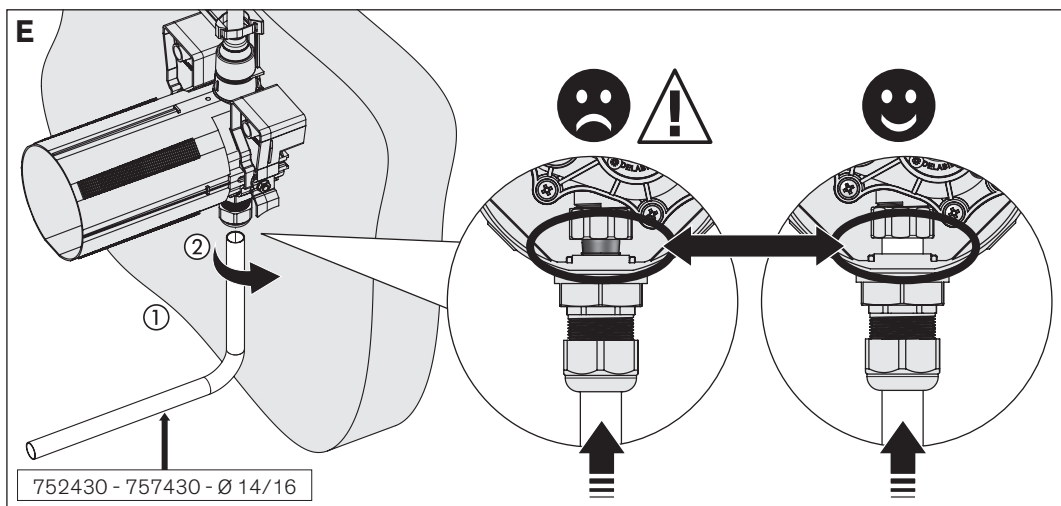
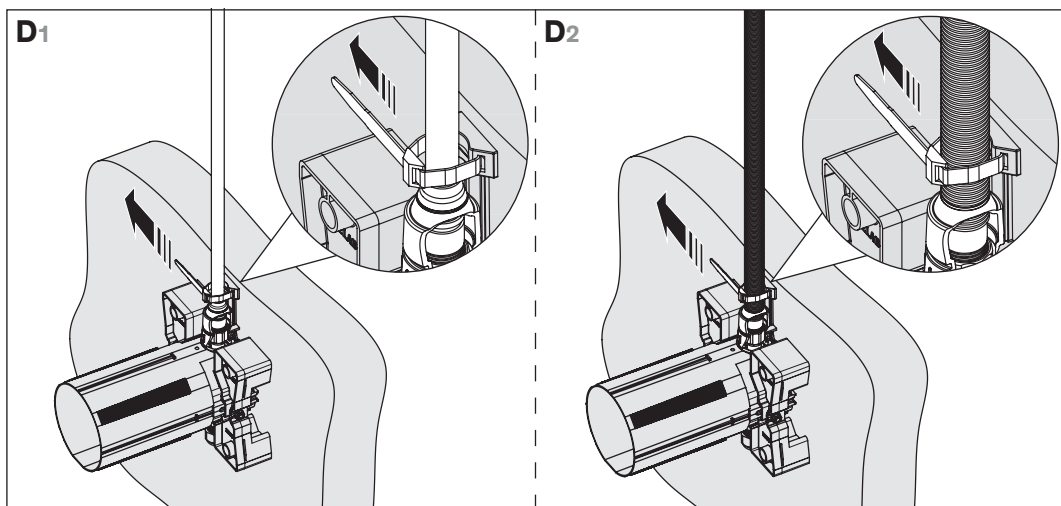
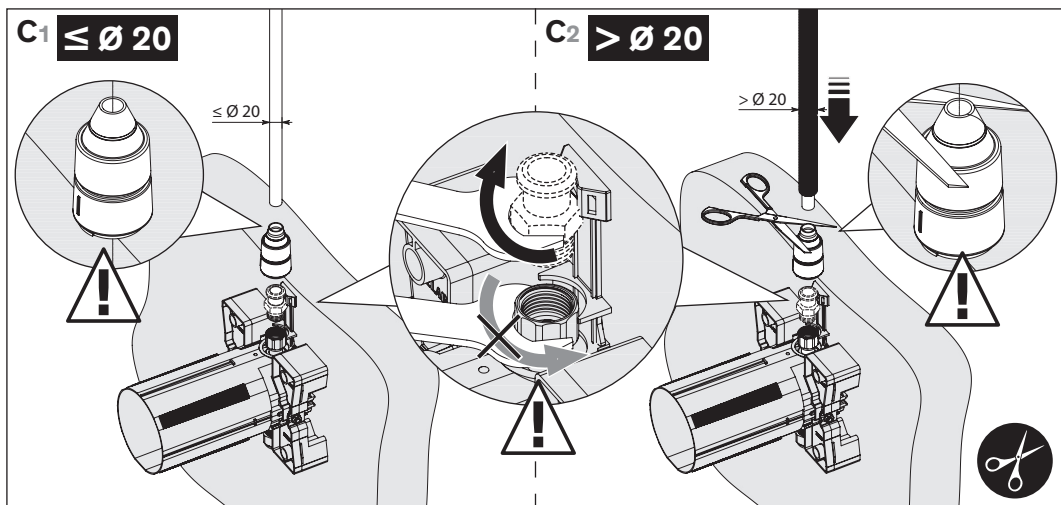

(F)

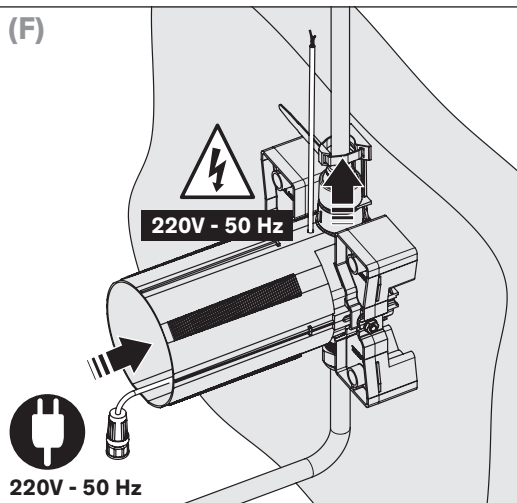

G

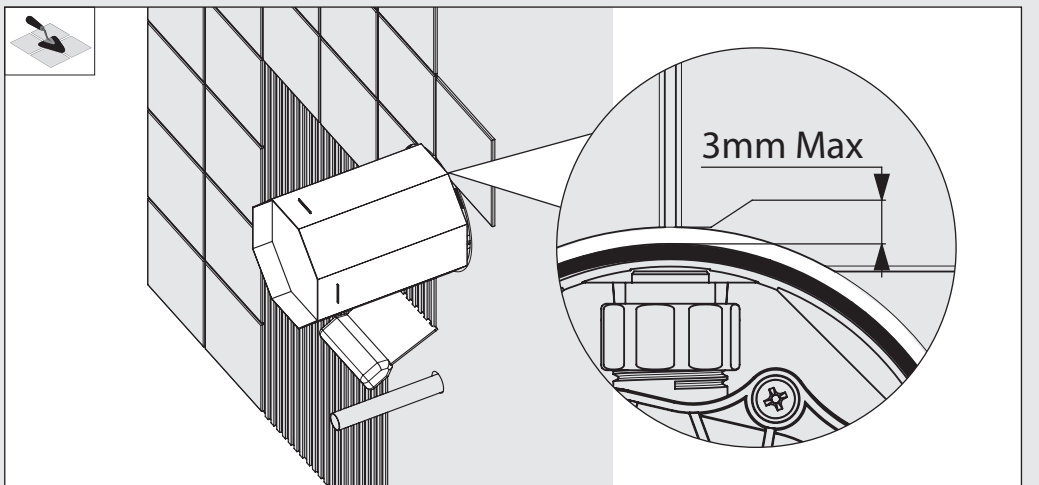
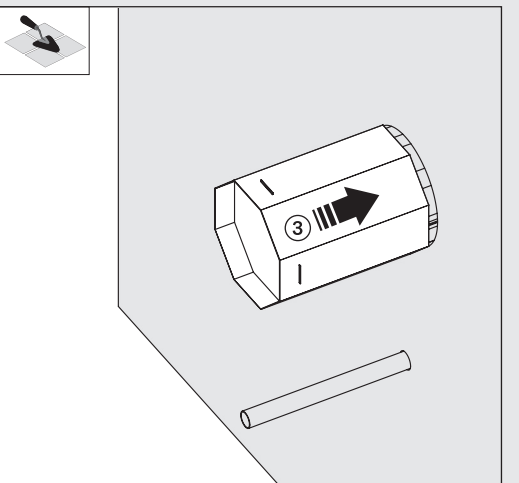
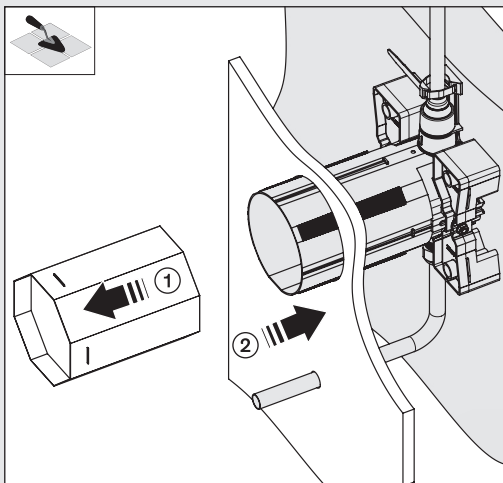
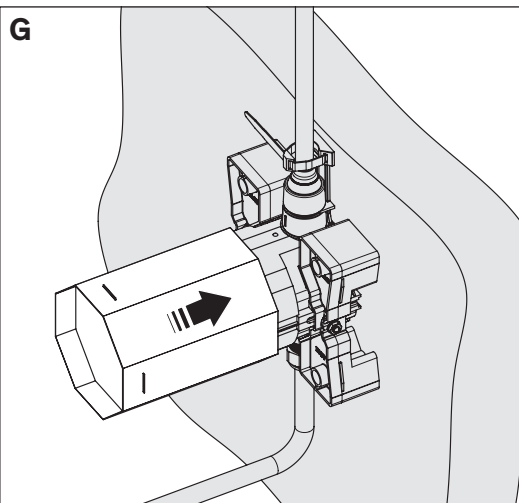

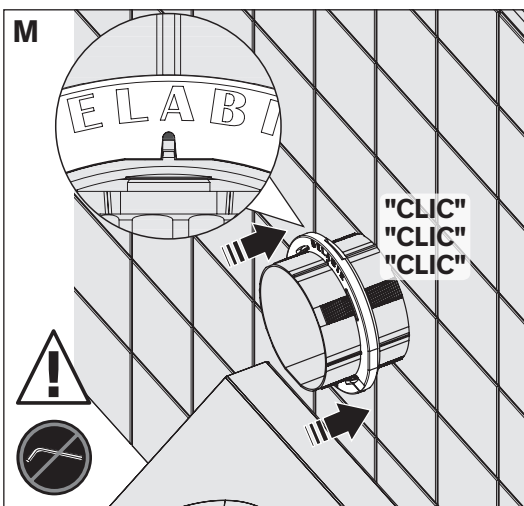
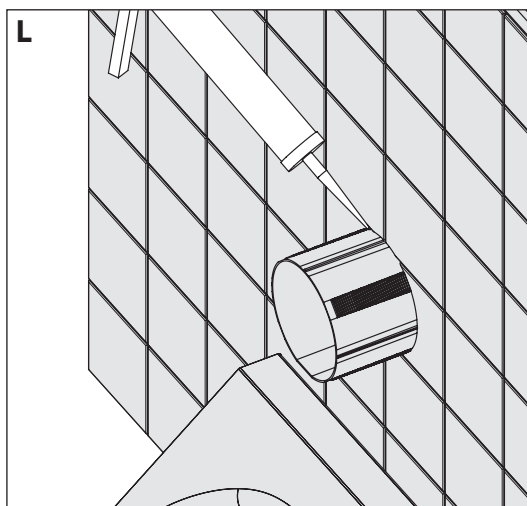
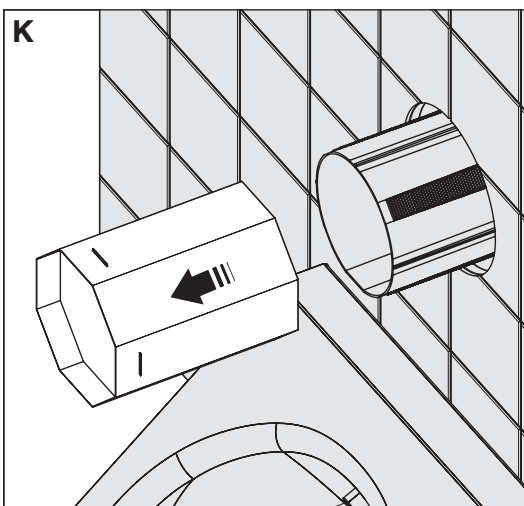
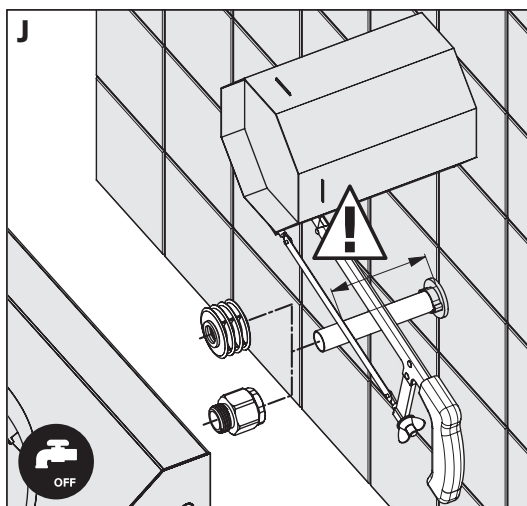
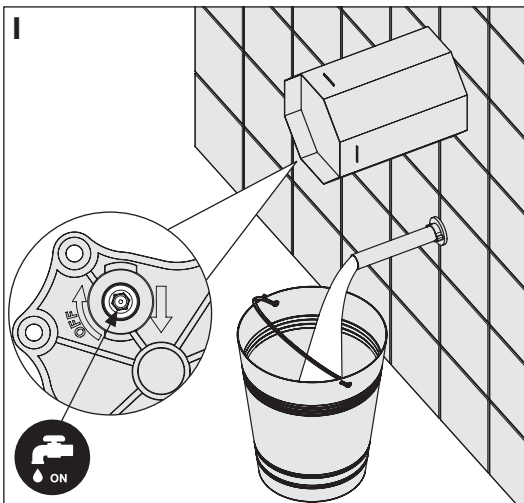
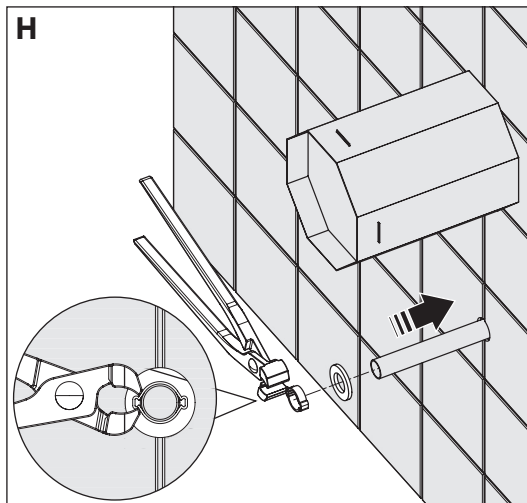

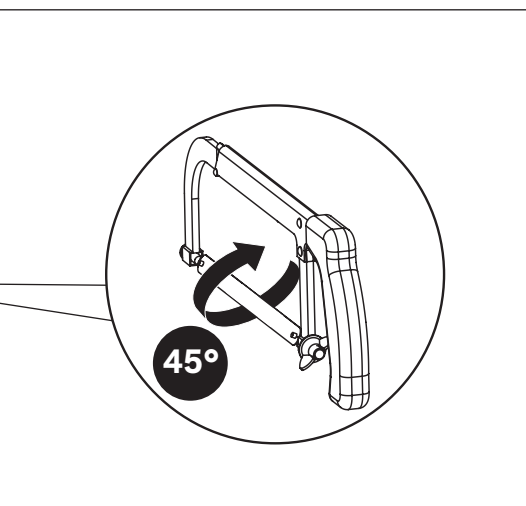
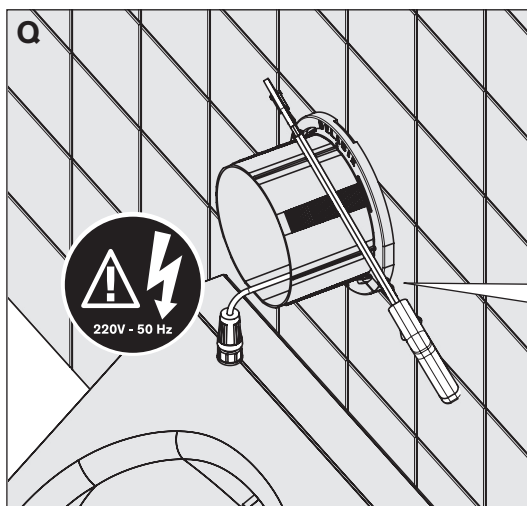
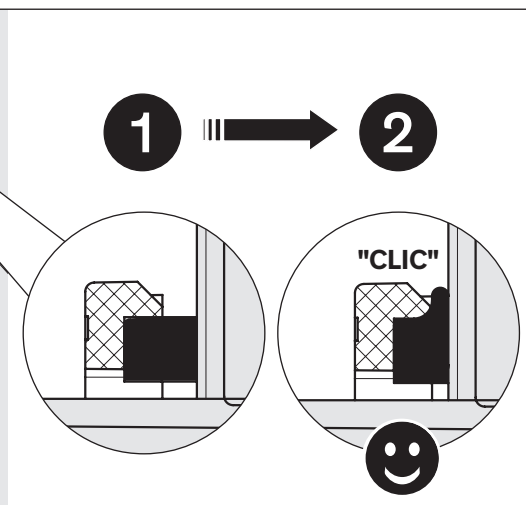
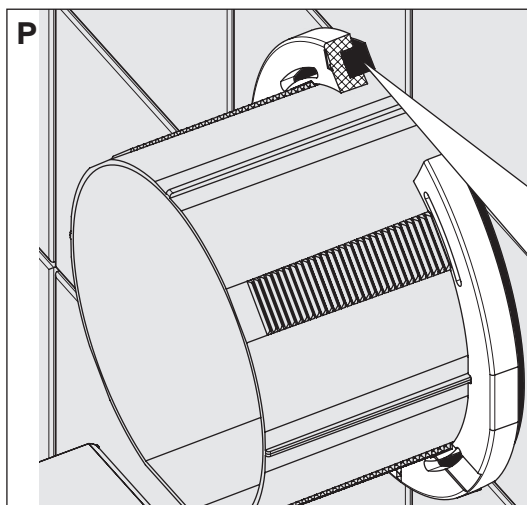
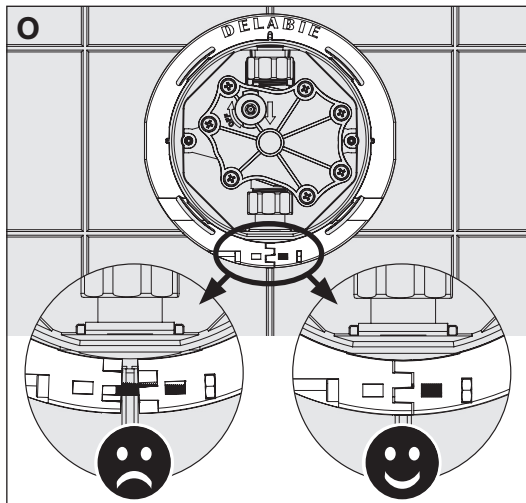
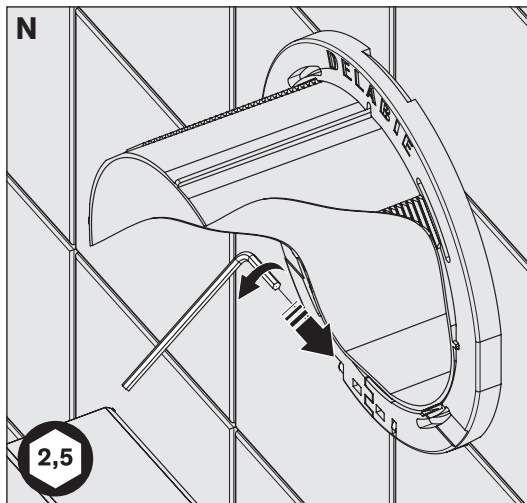

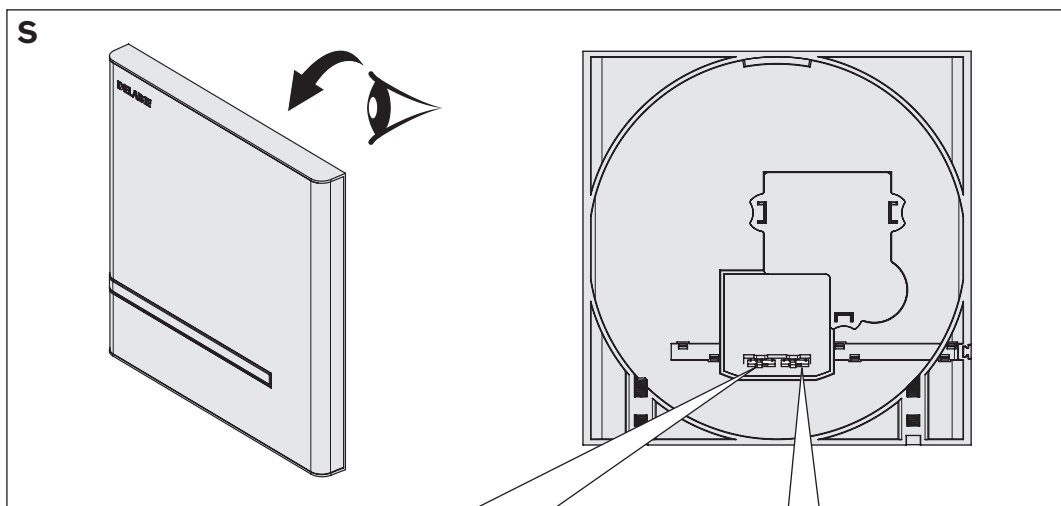
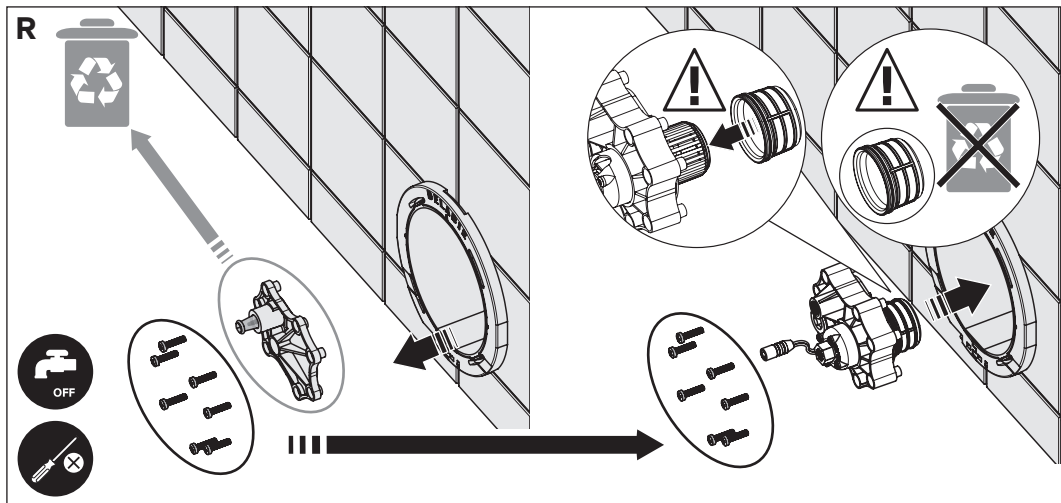

T

Diagram T illustrates the selection of the door panel. The panel is shown being inserted into the door. A warning symbol (exclamation mark) is shown next to the panel. The panel is shown being inserted into the door and then being turned to the 'OFF' position.

	3	2	1
n°1	3 s	2 s	2 s
n°2	8 s	4 s	2 s

U

Diagram U illustrates the selection of the door panel. The panel is shown being inserted into the door. A warning symbol (exclamation mark) is shown next to the panel. The panel is shown being inserted into the door and then being turned to the 'OFF' position.

24h	12h	0h
24H	12H	OFF

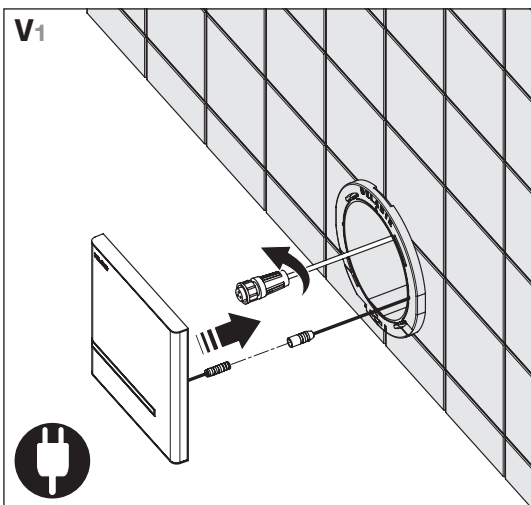
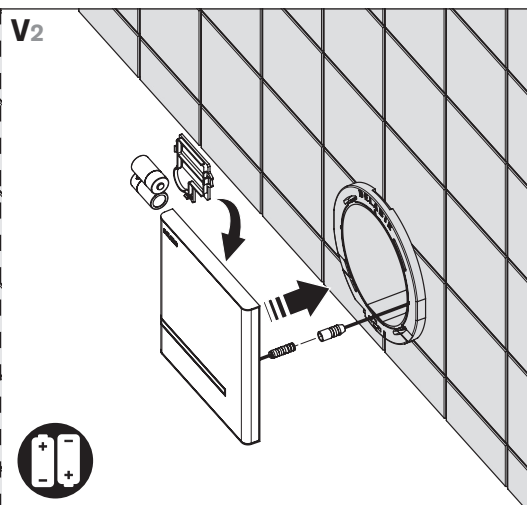
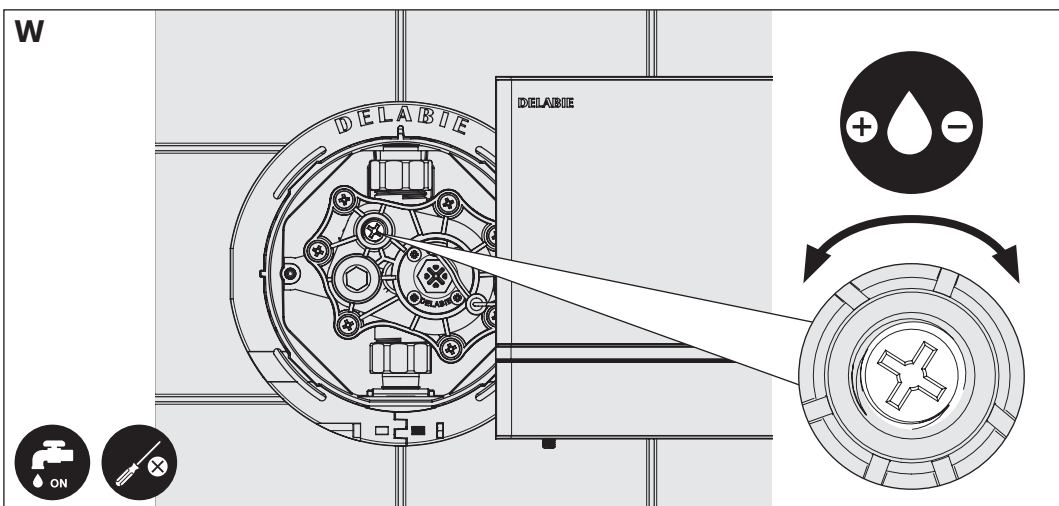
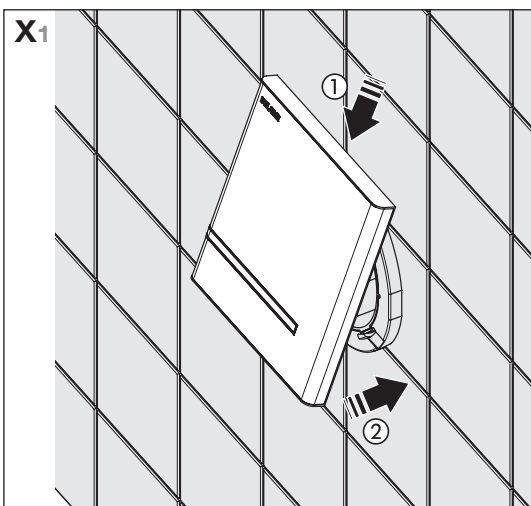
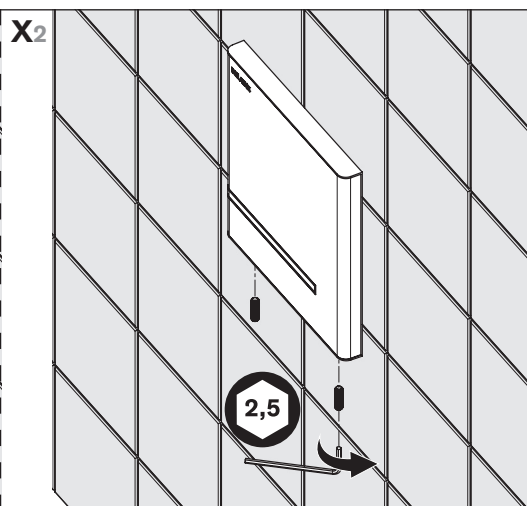
V1**V2****W****X1****X2**



AA

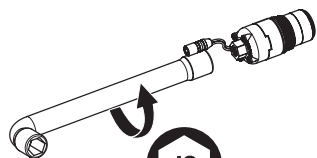

AB

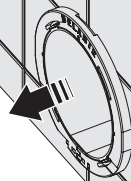
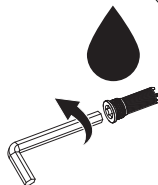

AC

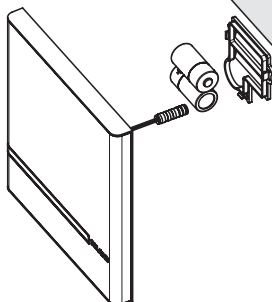
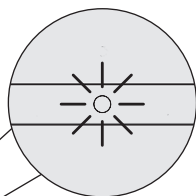
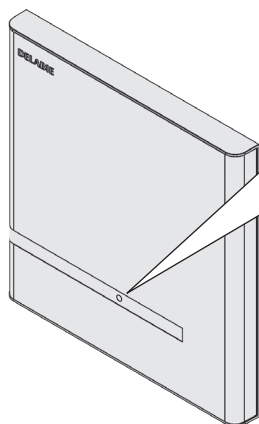

Electronic urinal valve:

- The installation must conform to local electrical regulations/standards
- Recommended pressure 1.5 - 5 bar.
- Flow rate for conventional urinals: 0.15 l/sec at 3 bar.
- Max. flow rate for TEMPOMATIC 4 at 1 bar: 0.37 l/sec. - at 2 bar: 0.52 l/sec - at 3 bar: 0.64 l/sec.
- Calculate the pipe work according to the probable flow rate and the dynamic pressure.
- Connect the TEMPOMATIC 4 to the pipe work using a pipe with a minimum internal diameter of 12mm.
- To avoid interference from infrared beams do not install the electronic mixer or tap opposite a mirror or bright object. Do not install two electronic mixers or taps opposite each other.

INSTALLATION

CHECK THE INTEGRITY OF THE SEALS BETWEEN THE STAINLESS STEEL WALL PLATE AND THE WALL AT LEAST ONCE A YEAR, AND MAKE GOOD IF NECESSARY.

If this advice is not followed, water may leak into the wall. DELABIE cannot be held responsible for any ingress.

FOR FURTHER INFORMATION PLEASE CALL TECHNICAL SUPPORT (SEE BELOW FOR CONTACT DETAILS).

REMEMBER

- **Our valves must be installed by professional installers** in accordance with current regulations and recommendations in your country, and the specifications of the fluid engineer.
- **Sizing the pipes correctly** will avoid problems of flow rate, pressure loss and water hammer (see calculation table in our brochure and online at www.delabie.com).
- **Protect the installation** with filters, water hammer absorbers and pressure reducers to reduce the frequency of maintenance (recommended pressure from 1.5 to 5 bar maximum).
- **Install stopcocks** close to the valve to facilitate maintenance.
- The pipework, filters, non-return valves, stopcocks, bib taps, cartridge and all sanitary fittings should be checked at least once a year, and more frequently if necessary.

OPERATION OF ELECTRONIC VERSIONS (Fig. T and U)

- Controlled by infrared presence detection: activates after 10 seconds of presence.
- Rinses once the user has departed:
 - Short rinse after user departs: 2 sec. or 3 sec. (**Fig. T**)
 - Additional rinse if no further users are detected within 20 seconds: 2 sec., 4 sec. or 8 sec. (**Fig. T**).
- Choice of programme 1, 2 or 3 depending on desired flush volume and urinal size.
During busy periods only the short rinse takes place between users, the additional rinse takes place after the busy period.
- Hygienic duty flush, every 12 hr, 24 hr (or Off) after the last use: prevents backflow (**Fig. U**).

MAINTENANCE & CLEANING

- **Cleaning chrome and stainless steel:** do not use abrasive, chlorine or any other acid-based cleaning products. Clean with mild soapy water using a cloth or a sponge
- **Frost protection:** drain the pipes and operate the valve several times to drain any remaining water.
In the event of prolonged exposure to frost, we recommend taking the mechanisms apart and storing them indoors.