

TEMPOSOFT/TEMPOSOFT 2
SOFT-TOUCH, TIME FLOW
MIXER/TAP AND VALVE

DELABIE

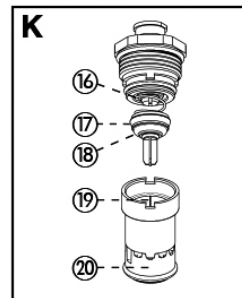

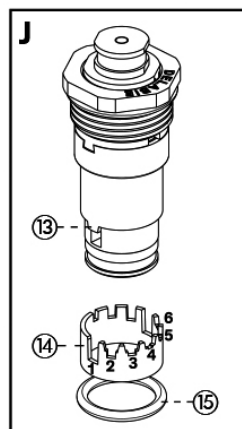
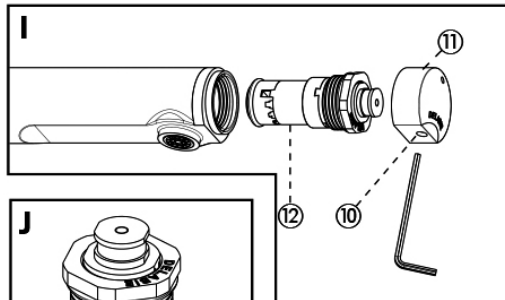
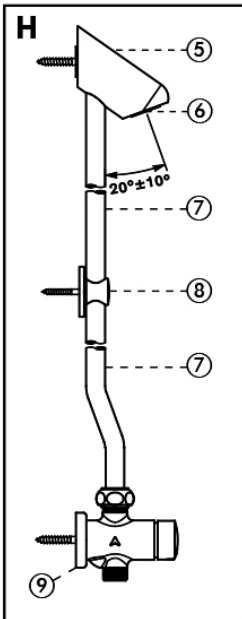
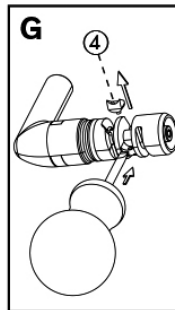
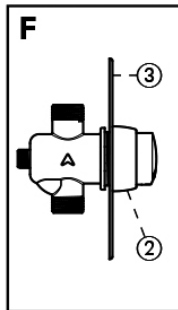
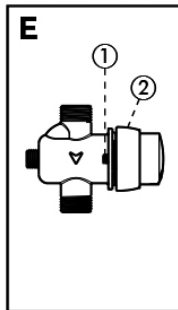
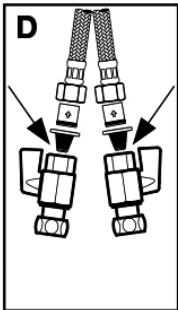
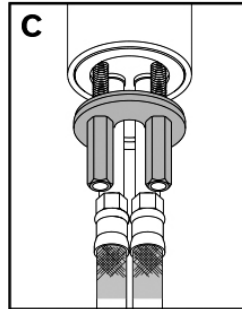
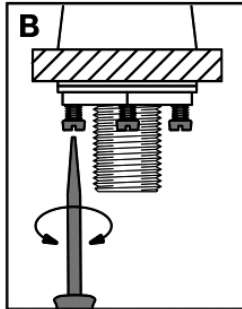
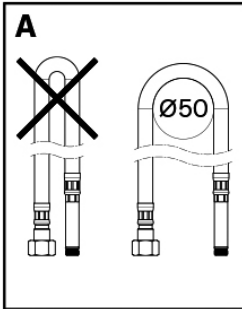

OPERATION

- Press the push-button control to open the valve.
- Mixer: temperature control via the side lever.
- Automatic shut-off after ~7 seconds for washbasins, ~3 or 7 seconds for urinals (depending on the model) and ~30 seconds for showers (+5/-5 at 3 bar).

INSTALLATION

- Tap: supply with cold water (insert the blue or grey marker) or mixed water (insert the red marker).
- Mixer: supply with cold water and hot water at 50°C (maximum recommended 70°C), and balance the pressure between the hot and cold water ($\Delta P < 1$ bar). Ensure that hot water is always delivered from the left side and cold from the right. Maximum supply pressure is 5 bar (we recommend 1 to 5 bar dynamic pressure). Take care not to pinch the PEX flexibles (fig. A).
- For shower and urinal models: respect the direction of the water flow, see arrow on the valve body.

Deck-mounted Washbasins

- Drill a \varnothing 21 mm diameter hole for installing taps and \varnothing 34 mm for mixers.
- Mount the mixer/tap body onto the washbasin and tighten the screws:
 - Tap: tighten the 3 stainless steel screws on the back-nut (fig. B), for models with a reinforced back-nut. For models with a simple back-nut, tighten directly on the back-nut.
 - Mixer: tighten the bolts (fig. C) on the fixing flange. Install the filter joints (fig. D) supplied, exactly as shown in the diagram. They will protect the nonreturn valves from damage.
- Ensure a waterproof seal between the mixer and the work surface that is appropriate for the type of installation.
- Connect the water supply and operate the valve several times to stabilise the time flow

Wall-mounted Model

- Tighten the tap directly onto the fittings recessed in the wall using the 15/21 supply tails.
- Connect the water supply and operate the valve several times to stabilise the time flow.

Wall-mounted Exposed Models (excluding ref. 747801)

- Mount the valve on the wall using the screw/screws provided (use rawl plugs that are suitable for the type of wall).
- Connect the water supply and operate the valve several times to stabilise the time flow.

Wall-mounted Exposed Shower Kit (ref. 747801) (fig. H)

- Fix the shower head ⑤ so that the nozzle ⑥ is 2.10m from the floor.
- Assemble the column ⑦ and the valve ⑨.
- Insert the column into the hole beneath the shower head ⑤. Fix the shower head ⑤ onto the wall (use rawl plugs that are suitable for the type of wall).
- Position the collar ⑧ in the middle of the column to cover the joint. Fix the collar ⑧ and the valve ⑨ to the wall (use rawl plugs that are suitable for the type of wall).
- Connect to the water supply and ensure that all the connections are waterproof. Operate the valve several times to stabilise the time flow.

Panel-mounted Models (fig. E)

- Drill a Ø 36mm diameter hole.
- Pass the valve through the panel.
- Tighten the nut ② against the panel.
- Tighten the 2 screws ① using a 3mm Allen key.
- Connect the water supply and operate the valve several times to stabilise the time flow.

Recessed Model (fig. F)

- The wall mounting area should measure: 90x90mm, with an adjustable depth of 50-60mm.
- Connect the valve to the water supply.
- Mount the wall plate against the wall and position the silicone seal behind the wall plate to provide a waterproof seal between the wall plate and the wall. Leave a drainage point to allow any residual water to drain away.
- Fix the wall plate ③ in place.
- Tighten using the nut ②.
- Activate the valve several times to stabilise the temperature.

THE INSTALLER MUST ENSURE:

- THE RECESSING AREA IS WATERPROOF TO PREVENT ANY INGRESS OF WATER;
- ANY WATER ACCIDENTALLY ENTERING THE RECESSING AREA (E.G. CONDENSATION, RUN OFF, LEAKS, ETC.) IS NOT STAGNANT AND HAS A DRAINAGE POINT;
- THE INTEGRITY OF THE SEALS BETWEEN THE STAINLESS STEEL WALL PLATE AND THE WALL OR THE WALL PLATE AND THE MIXER/TAP AT LEAST ONCE A YEAR, AND MAKE GOOD IF NECESSARY.

If this advice is not followed, water may leak into the wall. MacDonald Industries cannot be held responsible for any ingress. For further information please call technical support (see last page for contact details).

ADJUSTING THE FLOW RATE (FIG. I AND J)

The flow rate is set at the factory at 3 lpm for washbasins, 6 or 9 lpm for showers (Ref.s fitted with ROUND, TONIC JET or GYM shower heads are set at 6 lpm) and 9 lpm for urinals.

- Remove the grub screw ⑩ using a 2.5mm Allen key.
- Remove the push-button ⑪.
- Unscrew the cartridge ⑫ using a 28mm spanner.
- Remove the O ring ⑬ underneath the flow rate regulator ⑭.
- Remove the regulator ⑭ sliding it off the bottom of the cartridge, then align the marker ⑮ on the cartridge with the desired notch on the flow rate regulator ⑭:
 - Notch 1: maximum flow rate
 - Notch 6: minimum flow rate.

MAXIMUM TEMPERATURE LIMITER (ON MIXERS) (FIG.G)

The mixer is delivered with the temperature limiter engaged. For the UK and Northern Ireland market we recommend installing a thermostatic mixing valve to provide safe, temperature controlled hot water. **Where thermostatic mixing valves are installed, the temperature limiter MUST BE REMOVED.** To remove the limiter:

- Isolate the water supply.
- Loosen the grub screw at the back of the mixer body using a 4mm Allen key and remove the temperature selector.
- To remove the coloured limiter ④, prise upwards with a flat-headed screwdriver.

MAINTENANCE

Foreign bodies in the pipework can cause the mechanism to malfunction. To remove the mechanism (fig. I):

- Remove the grub screw ⑩ using a 2.5mm Allen key.
- Remove the push-button ⑪.
- Unscrew the cartridge ⑫ using a 28mm spanner.

Automatic shut-off takes too long or there is continuous flow (fig. K)

- Clean the inside of the delay case ⑭ using a clean, dry cloth; and clean the calibrated groove ⑮ with a non-metallic, sharp point.
- Check that the lip seal ⑯ and seat ⑰ are in good condition.
- Remember to replace the spring ⑱.

Dripping or a constant trickle (fig. K)

- Clean the seat ⑰ or replace if damaged.
- Remember to replace the spring ⑱.

Beware: do not grease the inside of the mechanism.

CLEANING & SERVICING

Cleaning chrome

- Do not use abrasive, chlorine or any other acid-based cleaning products. Clean with hot, soapy water and a clean cloth or sponge. Dry using a clean, dry cloth.

Frost protection

- Drain the pipes and operate the mixer several times to drain any remaining water.

REMEMBER

- **Our mixers/taps and valves must be installed by professional installers** in accordance with current regulations and recommendations in your country, and the specifications of the fluid engineer.
- **Sizing the pipes correctly** will avoid problems of water hammer and loss of pressure/flow rate. (See the calculation table in the brochure or on line at www.delabie.com).
- **Protect the installation** with filters, water-hammer absorbers or pressure reducers to reduce the frequency of maintenance. (Recommended dynamic pressure: 1-5 bar, 2 bar for siphon-action urinals) to facilitate maintenance.
- **Install stopcocks** close to the mixer to facilitate maintenance.
- The pipework, stopcocks, valves and all sanitary ware must be checked regularly.



**MACDONALD
INDUSTRIES LIMITED**

Auckland (Head Office)

20 Carr Rd, Three Kings

Auckland 1042

P: 09 624 1115

F: 09 624 1110

E: sales@macdonaldindustries.co.nz

Wellington

P: 04 569 8033

F: 04 569 8066

Christchurch

P: 03 348 2356

F: 03 348 2376

www.macdonaldindustries.co.nz