

Z-SF ZURN CLEANERS SINK FAUCET

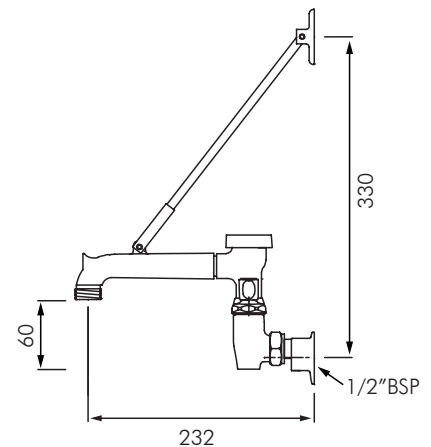
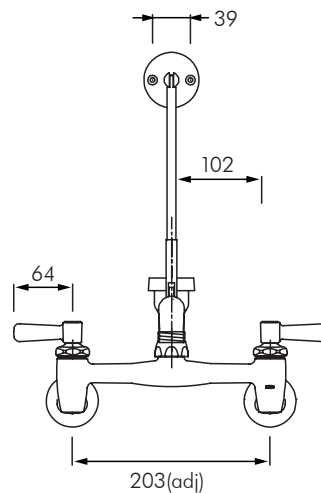

DESCRIPTION

Zurn Z-SF is a purpose made commercial grade wall mounted faucet suitable for use above cleaners sinks.

It is polished chrome plated cast brass with 1/4 turn ceramic disc cartridges, with eccentric swivel inlets allowing adjustable centres from 184mm to 222mm. Inlets include integral isolators allowing inline servicing. Valve spout includes chemical resistant vacuum breaker for backflow protection and 3/4" hose connection allowing use of Zurn Z-HH short hose. Valve has adjustable wall brace and bucket hook allowing buckets to be hung off faucets while filling.

INSTALLATION

Zurn Z-SF cleaners sinks faucets should be installed according to instructions supplied with each faucet at a height to suit the cleaners sink installed.

ACCESSORIES

Z-HH - 600mm hose and hanger bracket
Z-MH - Mop hanger bracket

TECHNICAL

Maximum Pressure: 860 kPa
Maximum Temperature: 82°C

MODEL

Z-SF - Cleaners Sink Faucet



**MACDONALD
INDUSTRIES LIMITED**

Auckland (Head Office)

20 Carr Rd, Three Kings
Auckland 1041
P: 09 624 1115

E: sales@macdonaldindustries.co.nz

Wellington

P: 04 569 8033

www.macdonaldindustries.co.nz

Christchurch

P: 03 348 2356

Z-SF ZURN CLEANERS SINK FAUCET



At MacDonald Industries we understand the current requirements for taps within commercial buildings, where the majority of taps will need a WELS Rating (Water Efficiency Labelling Scheme) where the water consumption of a building is measured through the taps used and their tested and certified water flow rates measured in l/min (Litres per minute)

GreenStar buildings Cleaners sink faucet information:

Within the technical resources from the NZGBC (New Zealand Green Building Council) who created and administer the Greenstar rating tool there are allowances made for fixtures where water consumption will not be altered ie. Filling a cleaners bucket of water will use the same amount of water regardless of how quickly the water flows.

The following fixtures and fittings may be excluded, as the water consumption will not be altered significantly by reducing the water flow:

- Bath taps, laboratory taps, and taps dedicated to cleaning and facility management.
- Kitchen or café tap ware, where the primary use is for pot fill and container filling.
- Kitchen/ Café Chilled, Boiling and Sparkling tapware which are used to fill cups.

For more information visit NZGBC Website:

Green Buildings --->
Green Start Buildings & Communities --->
How it Works ---> Submission Guidelines --->
Greenstar Design & As Built New Zealand v1.1.1 Pg. 208

This PDF is enough to support a submission and will satisfy any GSAP's RFI.

For further information on this or any other product related enquiry for Greenstar or low energy buildings or any product related sustainability enquiry or to see how we can help you further with products for low impact in building design please give MacDonald Industries head office a call and ask for our Sustainability Lead



**MACDONALD
INDUSTRIES LIMITED**

Auckland (Head Office)

20 Carr Rd, Three Kings
Auckland 1041
P: 09 624 1115

E: sales@macdonaldindustries.co.nz

Wellington

P: 04 569 8033

www.macdonaldindustries.co.nz

Christchurch

P: 03 348 2356