

**ZURN AQUASPEC FAUCETS**  
MODEL - Z-SF SERIES, SINK FAUCET

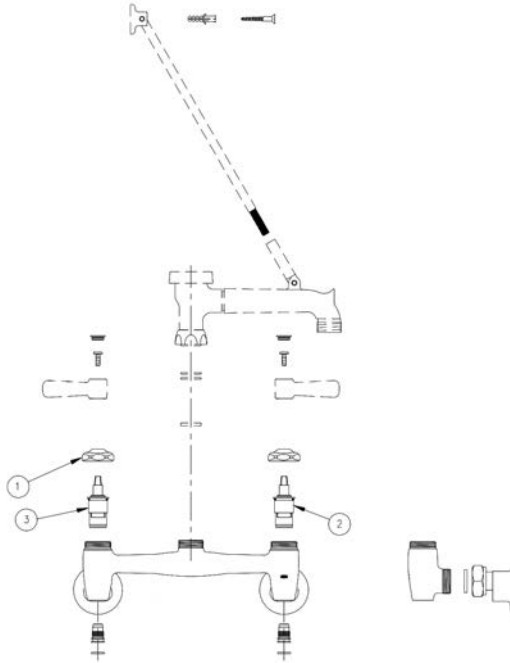

**Maximum Pressure:** 860 KpA  
**Maximum Temperature:** 82°C  
**Cartridge Style:** Quarter Zurn Ceramic Disk

**Z-SF PARTS LIST**

ITEM		QTY
1	Z-SF-RK2 HANDLE NUT	2
2	Z-SF-RK3 SHORT COLD CARTRIDGE	1
3	Z-SF-RK4 SHORT HOT CARTRIDGE	1

# MACDONALD INDUSTRIES LIMITED

## INSTALLATION INSTRUCTIONS

### 1.0 INSTALLATION INSTRUCTIONS

- 1.1 1/2" BSP nipple should protrude 10mm from the finish wall on 200 centres. Supply pipes should be secured to support the faucet.
- 1.2 Apply pipe sealant to 1/2" threads of supply pipe and screw supply arm assembly (item#5) onto pipe. Position supplies so that the body connections end up at 200 centres on a horizontal plane.
- 1.3 Insert sink faucet body (item #4) to supply arms placing gasket (item#5A) between body and supply arm.
- 1.4 Assemble spout to body using hardware.
- 1.5 Install wall brace by screwing the support rod into the threaded spout connection. Adjust the support rod to desired length and secure to finished wall using the two wood screws provided. Note: Support for finished wall is recommended where wall brace mounts for maximum support.
- 1.6 Turn water supply on and operate faucet checking for leaks.
- 1.7 It may be necessary to shut water off and remove cartridges to clean supply lines. Cartridges can be removed by first removing the handles. Colour indexes can be removed by inserting a pin into the hole on the underside of the handle. After the handles have been removed unscrew the handle nuts and pull out on the cartridge.
- 1.8 Replace cartridges in body and hand tighten handle nuts. Place handles on the cartridge stem and locate them as desired. Tighten handle nuts.
- 1.9 Replace handle screws and colour index button.
- 1.10 If necessary, install aerator into spout and hand tighten. It may be necessary to unscrew and clean aerator at start-up.

### 2.0 SERVICE INSTRUCTIONS

Your Zurn Aquaspec Faucet is furnished with integral supply stops to provide a complete shut off of the water supply. Turn screw stops into body using 5/16" hex key wrench until water shuts off completely. Turn stop no more than three (3) complete turns to activate water flow.

### 3.0 MAINTENANCE

- 3.1 Your Zurn Aquaspec Faucet has a rough polish nickel chrome plated finish. Clean with soap and water or a mild cleaner. Do not use acids or toilet bowl cleaner as they will damage the finish.
- 3.2 Aquaspec Faucets contain ceramic disk cartridges which require no maintenance. To remove the cartridge, shut off, loosen the handle nuts and pull up on the cartridge.

### 4.0 REPLACEMENT PARTS

Cold Water Cartridge Z-SF-RK3  
Lever Handle Indicator Z-SF-RK1

Hot Water Cartridge Z-SF-RK4



**MACDONALD  
INDUSTRIES LIMITED**

#### **Auckland (Head Office)**

20 Carr Rd, Three Kings  
Auckland 1041  
P: 09 624 1115  
F: 09 624 1110

E: [sales@macdonaldindustries.co.nz](mailto:sales@macdonaldindustries.co.nz)

#### **Wellington**

P: 04 569 8033  
F: 04 569 8066

#### **Christchurch**

P: 03 348 2356  
F: 03 348 2376

[www.macdonaldindustries.co.nz](http://www.macdonaldindustries.co.nz)