

ZURN - ZH-6152XL & ZDF-6152XL MAINTENANCE HYDRAULIC FLUSHING



PROBLEM	CAUSE	CORRECTIVE ACTION
Valve will not operate.	<ol style="list-style-type: none"> 1. Hydraulic Actuator plunger orifice by-pass hole blocked. 2. Water supply shut off. 3. Internal valve filter is plugged. 4. Tubing is hooked up improperly. 5. Damaged or worn seals in Hydraulic Actuator. 	<ol style="list-style-type: none"> 1. Remove and disassemble by-pass orifice and clean if necessary, being careful not to enlarge orifice opening. 2. Turn on water supply/stop valve. 3. Remove filter and do not replace. 4. Refer to instructions for proper connections. 5. Replace Hydraulic Actuator.
Insufficient volume of water to adequately evacuate.	<ol style="list-style-type: none"> 1. Stop valve is not open enough. 2. Insufficient water supply. 3. Urinal trip mechanism installed in closet valve. 4. Inadequate supply running pressure. 5. Diaphragm kit is not matched to the fixture. 	<ol style="list-style-type: none"> 1. Open stop valve until desired flush. 2. Ensure that pipework is adequate for the installation as per supply volume and pressure. 3. Replace black urinal trip mechanism with a white closet trip mechanism. 4. To determine if the supply is adequate to evacuate the fixture, remove all working parts except for the diaphragm, then open the stop valve and evaluate flush. 5. Replace diaphragm kit with proper assembly.
Flush valve shuts off too quickly or is short flushing.	<ol style="list-style-type: none"> 1. Damaged or punctured diaphragm. 2. Incorrect flow ring installed. 3. Lip seal in Hydraulic actuator folded. 	<ol style="list-style-type: none"> 1. Replace diaphragm to remedy problem. 2. Replace flow ring with appropriate flow ring. 3. Straighten seal or replace hydraulic actuator.
Flush valve will not shut off.	<ol style="list-style-type: none"> 1. Trip mechanism is not seating properly. 2. Diaphragm by-pass orifice is plugged or partially plugged. 	<ol style="list-style-type: none"> 1. Disassemble parts and clean thoroughly. 2. Examine diaphragm by-pass orifice and clean if necessary, being careful not to enlarge orifice opening.
Continuous trickle of water through valve.	<ol style="list-style-type: none"> 1. Tubing is hooked up back to front 2. Debris lodged between piston assembly and valve seat. 	<ol style="list-style-type: none"> 1. Refer to instructions for proper connections. 2. Remove the piston from the push button assembly and inspect and clean both the spool and the valve seat.
Actuator assembly leaking.	<ol style="list-style-type: none"> 1. Actuator assembly handle nut is loose. 2. Actuator assembly gasket(s) are missing 	<ol style="list-style-type: none"> 1. Tighten the actuator assembly nut. 2. Install gaskets.
Push button assembly leaking.	<ol style="list-style-type: none"> 1. Compression fitting or nuts are loose 2. Piston O-Ring is damaged. 	<ol style="list-style-type: none"> 1. Tighten nuts or fittings. 2. Replace piston assembly.
Valve flushes once but wont flush again.	<ol style="list-style-type: none"> 1. By-pass hole in hydraulic actuator pin blocked. 	<ol style="list-style-type: none"> 1. Disassemble hydraulic actuator and clean out by-pass orifice.



ZH-6152XL

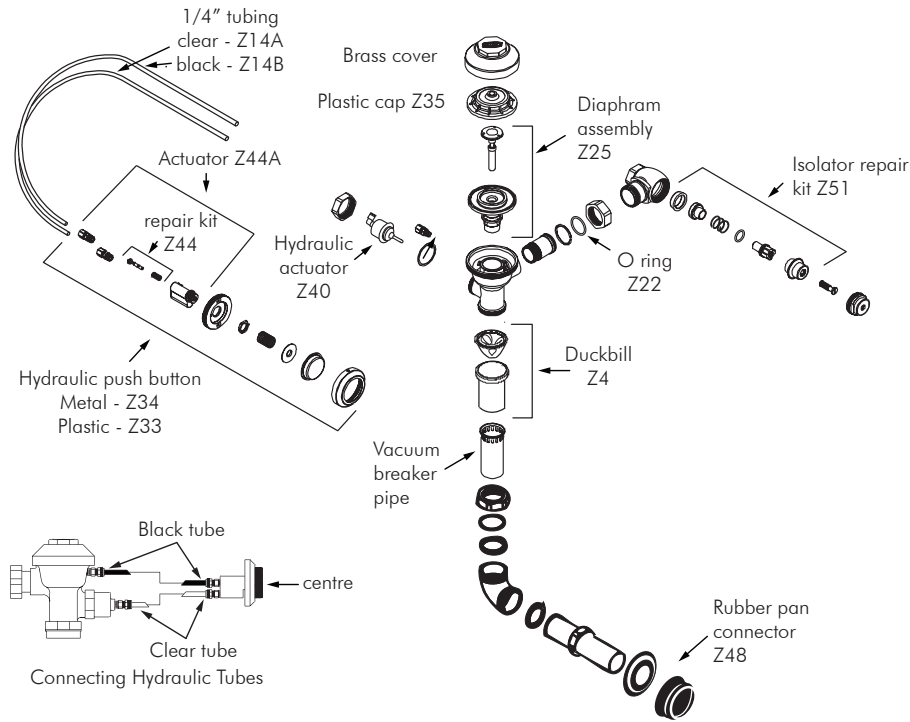

ZDF-6152XL

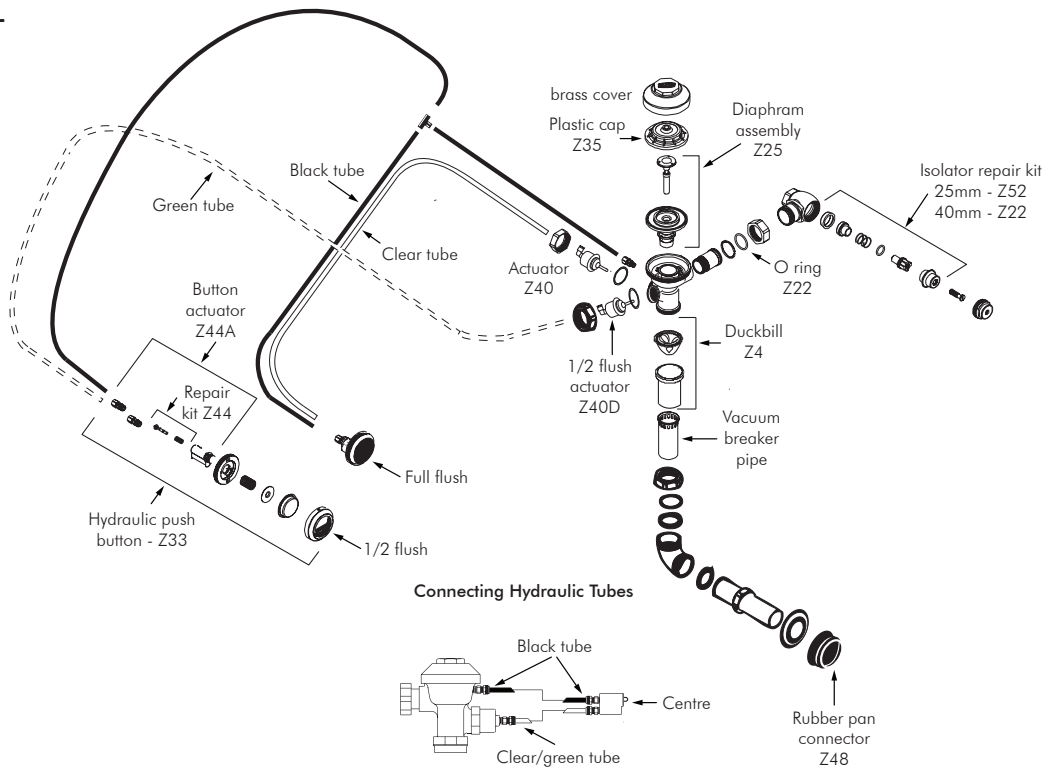

Auckland (Head Office)
 20 Carr Rd, Three Kings
 Auckland 1042
 09 624 1115
 sales@macdonaldindustries.co.nz
 macdonaldindustries.co.nz

Christchurch
 32B Hayton Road
 Wigram, Christchurch
 03 348 2356
 christchurch@macdonaldindustries.co.nz

Wellington
 04 569 8033